



## Coulgate Street, SE4

£2,250 Per calendar month

Located on the second floor of a private apartment block, this well-presented two-bedroom apartment with a private balcony offers bright and contemporary living in a sought-after location. Just a short walk from Brockley station, the property provides excellent transport links and easy access to local amenities.

Brockley station is a short walk away from where there are fast and frequent services into London Bridge. In addition, you can pick up the London Overground towards Shoreditch and Highbury and Islington meaning that Canary Wharf is a mere 30-minute commute changing at Canada Water.

### Features

- Modern Development
- Two Double Bedrooms
- One Bathroom
- Private Balcony
- Excellent Condition
- Close To Brockley Station

# Coulgate Street, London, SE4

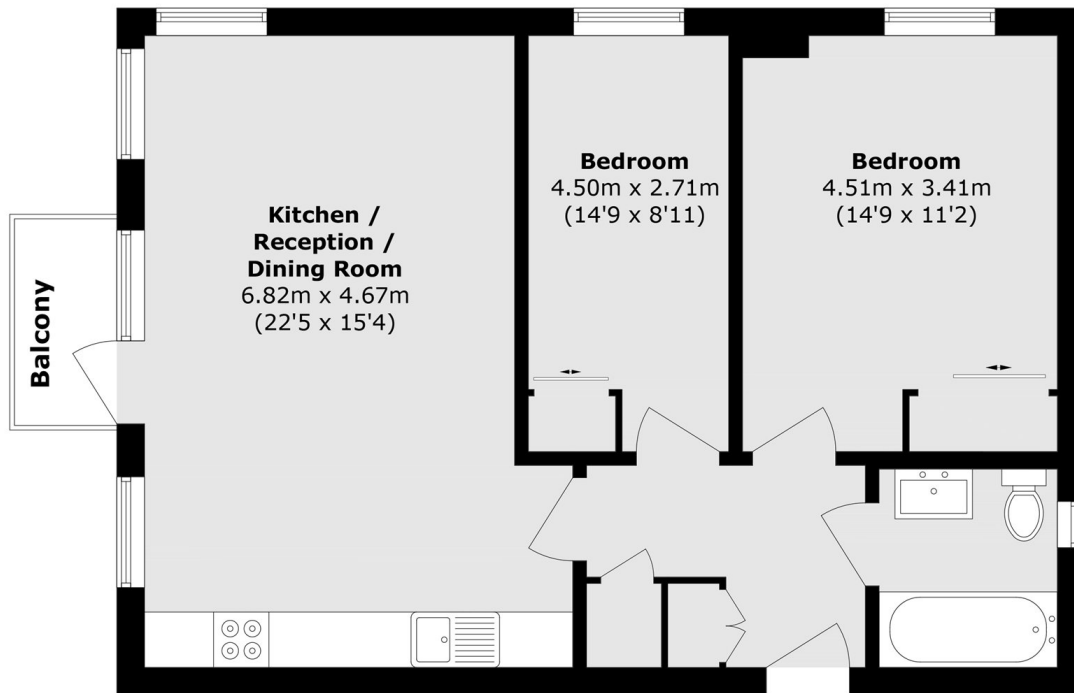

Total area (approx.): 67.7 sq. m (728.7 sq. ft)  
Balcony area (approx.): 2.4 sq. m (25.8 sq. ft)