

Sebastian Roche



Brookbank Road, SE13

£2,000 pw (pcm)

A three bedroom house located close to Lewisham Station and offered to the market in excellent condition.

Brookbank Road is a quiet residential road located close to Lewisham Station which has regular services into central London. The beautiful open spaces of Hilly Fields are also close by.

- Three Bedrooms • Kitchen Dining Room • Reception room •
- Bathroom • Close to transport links •

Sebastian Roche

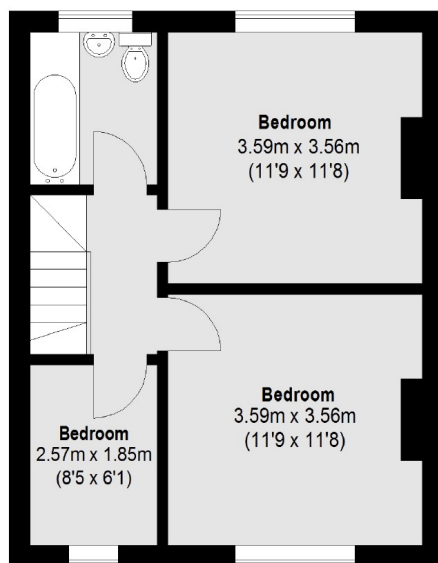

First Floor

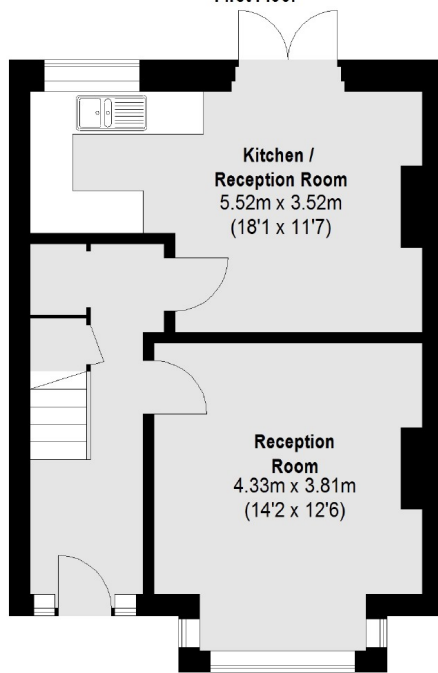

Ground Floor

Total area (approx.): 82.83 sq. m (891 Sq. ft)

Sebastian Roche Honor Oak & Forest
61 Honor Oak Park,
London, SE23 1EA
020 8291 9441
honoroaklettings@sebastianroche.com

Energy Rating: 0 We aim to make our particulars both accurate and reliable. However they are not guaranteed; nor do they form part of an offer or contract. If you require clarification on any points then please contact us, especially if you're traveling some distance to view. Please note that appliances and heating systems have not been tested and therefore no warranties can be given as to their good working order.

