



Seven Sisters Road, N4

£500,000

This contemporary three bedroom apartment features a spacious open plan reception area with direct access to a private balcony, a modern fitted kitchen, access to a communal courtyard and bike storage.

Piccadilly Line, Victoria Line and National Rail connections can be reached by a short walk to Manor House station or Finsbury Park station. The property is close to a plethora of independent shops, bars and cafes.

Features

- Modern Development
- Three Bedroom
- Balcony
- Leasehold
- Excellent Transport Links
- High Energy Efficiency

Seven Sisters Road, London, N4

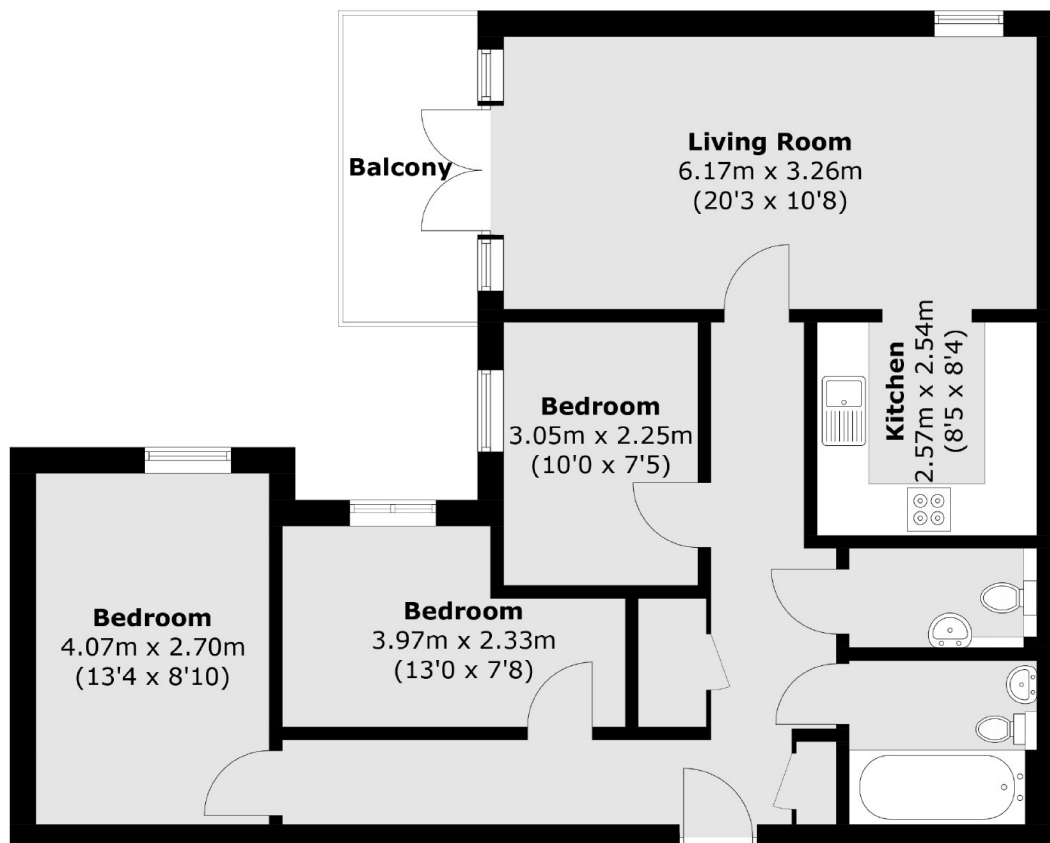

Total area (approx.): 77.0 sq. m (828.8 sq. ft)
Balcony: 55.5 sq. m (59.2 sq. ft)