



## Drayton Park, N5

### £420,000

A modern two double bedroom apartment located within a secure development with concierge and lift access. It has a modern open plan kitchen and reception with wooden flooring and a balcony plus a spacious bathroom with shower over bath.

Ashburton Triangle is located off Drayton Park which is just moments from Arsenal tube station as well as being within easy reach of Drayton Park, Holloway Road and Highbury & Islington stations.

### Features

- Two Double Bedrooms
- Open Plan Living
- Balcony
- Concierge
- Lift Access
- Excellent Location

# Drayton Park, London, N5

## Fifth Floor

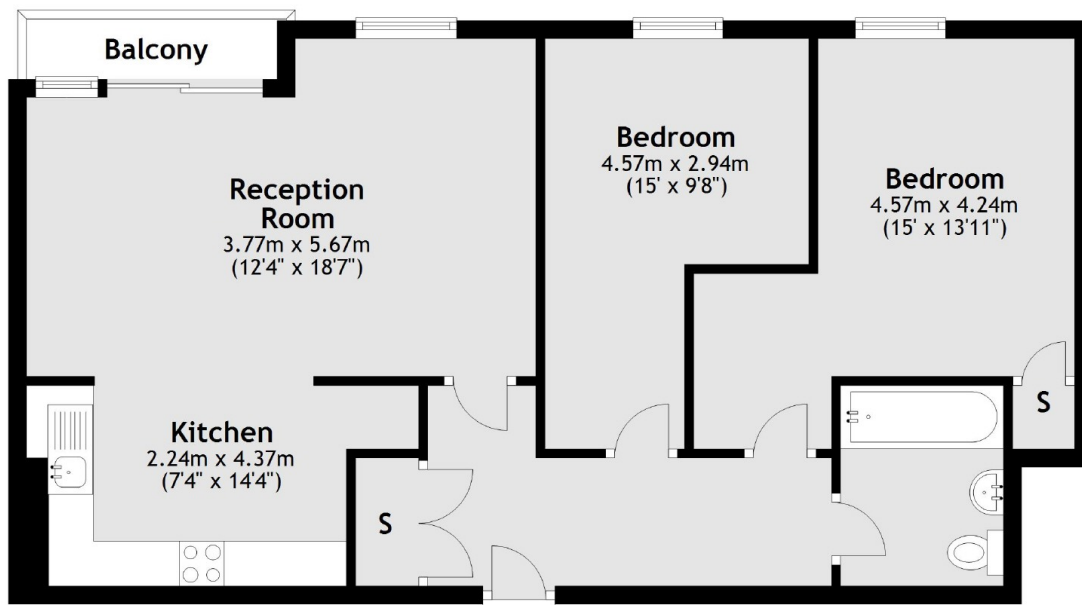

Total area: approx. 68.0 sq. metres (732.0 sq. feet)

# Dexters

Finsbury Park  
87 Stroud Green Road  
Finsbury Park  
London  
Sales  
020 7483 6360

Energy Rating: C. We aim to make our particulars both accurate and reliable. However they are not guaranteed; nor do they form part of an offer or contract. If you require clarification on any points then please contact us, especially if you're traveling some distance to view. Please note that appliances and heating systems have not been tested and therefore no warranties can be given as to their good working order.

 **RICS** | Regulated  
Estate Agent  
and Letting Agent

[dexters.co.uk](https://www.dexters.co.uk)