



Pooles Park, N4

£600,000

A well presented two bedroom garden flat set within a purpose built development. The property features two double bedrooms, a spacious open plan kitchen and living area and the added benefit of a private garden.

Pooles Park is ideally located close to a variety of shops and the open green spaces of Finsbury Park, with Finsbury Park station nearby offering Piccadilly and Victoria line services, as well as National Rail connections to the City.

Features

- Two Double Bedrooms
- Private Garden
- Chain Free
- Purpose Built
- Leasehold
- Great Transport Links

Pooles Park, London, N4

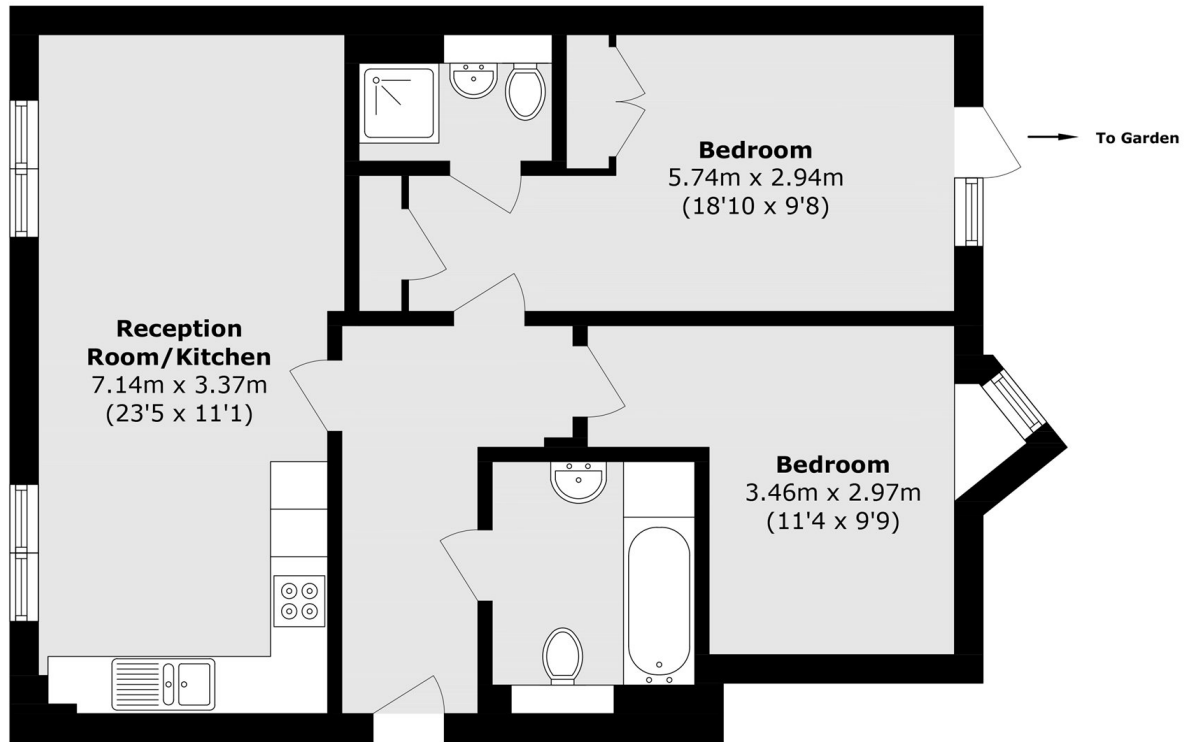

Total area (approx.): 67.0 sq. m (721.1 sq. ft)