



Mycenae Road, SE3

£575,000

A beautifully presented two-bedroom period conversion located on one of Blackheath's most desirable roads, within the heart of the Westcombe Park Area. Occupying the ground floor of an elegant Victorian building, this spacious apartment offers just over 750 sq ft of well-proportioned living space, with high ceilings and large sash windows throughout that flood the property with natural light.

Perfectly positioned just moments from Westcombe Park Station (Zone 3), residents benefit from excellent transport links into London Bridge, Cannon Street, and beyond. The green open spaces of Greenwich Park, Blackheath Common and Mycenae Gardens are also

Features

- Chain Free
- Private Decking
- Share Of Freehold
- Stunning Road
- Victorian Conversion
- Minutes From The Station



Mycenae Road, SE3

The property comprises two bedrooms, a stylish newly refurbished bathroom, and a bright, open-plan living/dining area with a contemporary kitchen tucked to one side ideal for both relaxing and entertaining.

Set back on a quiet, tree-lined street, the home retains much of its original charm while offering the benefits of modern upgrades and also direct access to your private decked area.



Mycenae Road, London, SE3

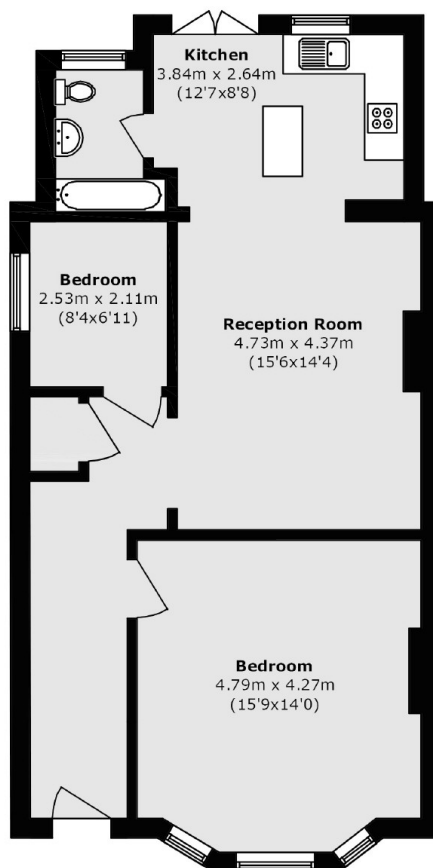

Total area (approx.): 70.6 sq. m (759.9 sq. ft)

Dexters

Blackheath
1 Stratheden Road
London
SE3 7SX
Sales
020 8815 2200

Energy Rating: C. We aim to make our particulars both accurate and reliable. However they are not guaranteed; nor do they form part of an offer or contract. If you require clarification on any points then please contact us, especially if you're traveling some distance to view. Please note that appliances and heating systems have not been tested and therefore no warranties can be given as to their good working order.

 **RICS** | Regulated
Estate Agent
and Letting Agent

[dexters.co.uk](https://www.dexters.co.uk)