



## Harefield Mews, SE4

### £400,000

Set on the ground floor of an attractive modern mews development, this stylish apartment enjoys exclusive access to a beautiful west facing rear garden perfect for afternoon sun and relaxed outdoor living. Inside, the property offers a stunning 23ft open-plan living space, designed in a contemporary style that's ideal for both entertaining and everyday comfort.

Tucked away on a charming cobbled street within the Brockley Conservation Area, you'll be just moments from the Overground and an excellent selection of independent cafés, bars, and eateries, giving this home the perfect blend of tranquillity and convenience.

### Features

- Double Bedroom
- Open Plan
- Ground Floor
- Private Garden
- Close To Transport Links
- Near To Aamenities

# Harefield Mews, London, SE4

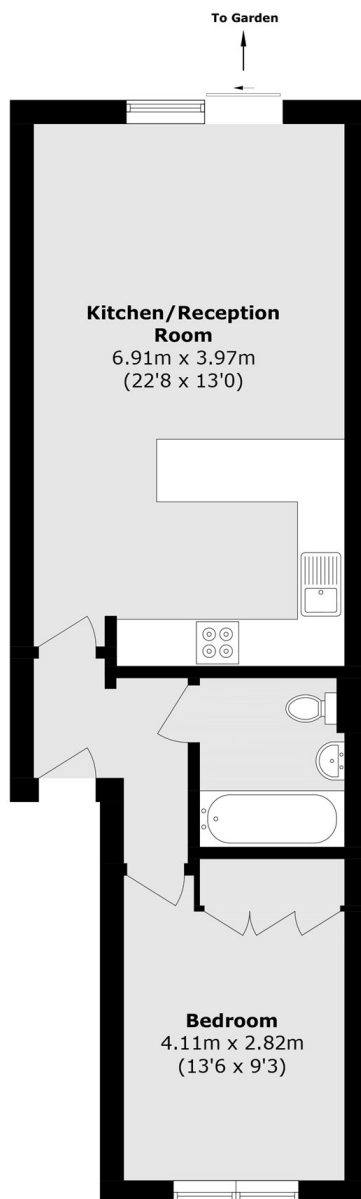

Total area (approx.): 47.6 sq. m (512.3 sq. ft)