



Milborough Crescent, SE12
£700,000

Dexters



Milborough Crescent, SE12

A beautifully modernised three bedroom mid-terrace home on Milborough Crescent, retaining charming original features throughout. The property offers a bright front reception room with open fire, a spacious open-plan kitchen/diner with wood burner and solid wood parquet flooring. Upstairs is a generous family bathroom with walk-in shower, roll-top bath and traditional fittings.

There is an 8m front garden with on-street parking and a 30m mature rear garden with raised beds, greenhouse and a fully powered garden office with separate storage. The home also benefits from an original stained-glass front door, replica timber double-glazed windows and traditional cast iron radiators.

With no upward chain and scope to extend (subject to planning), this is a fantastic opportunity for buyers looking to create a long-term home in SE12.

The home is ideally located near both Lee and Hither Green stations, the popular Manor House Gardens, and several outstanding primary schools.

Features

- Mid Terrace Family Home
- Three Bedrooms
- Open Plan Kitchen/Diner
- Spacious Bathroom
- Enclosed Rear Garden
- Well Presented Throughout







Milborough Crescent, London, SE12

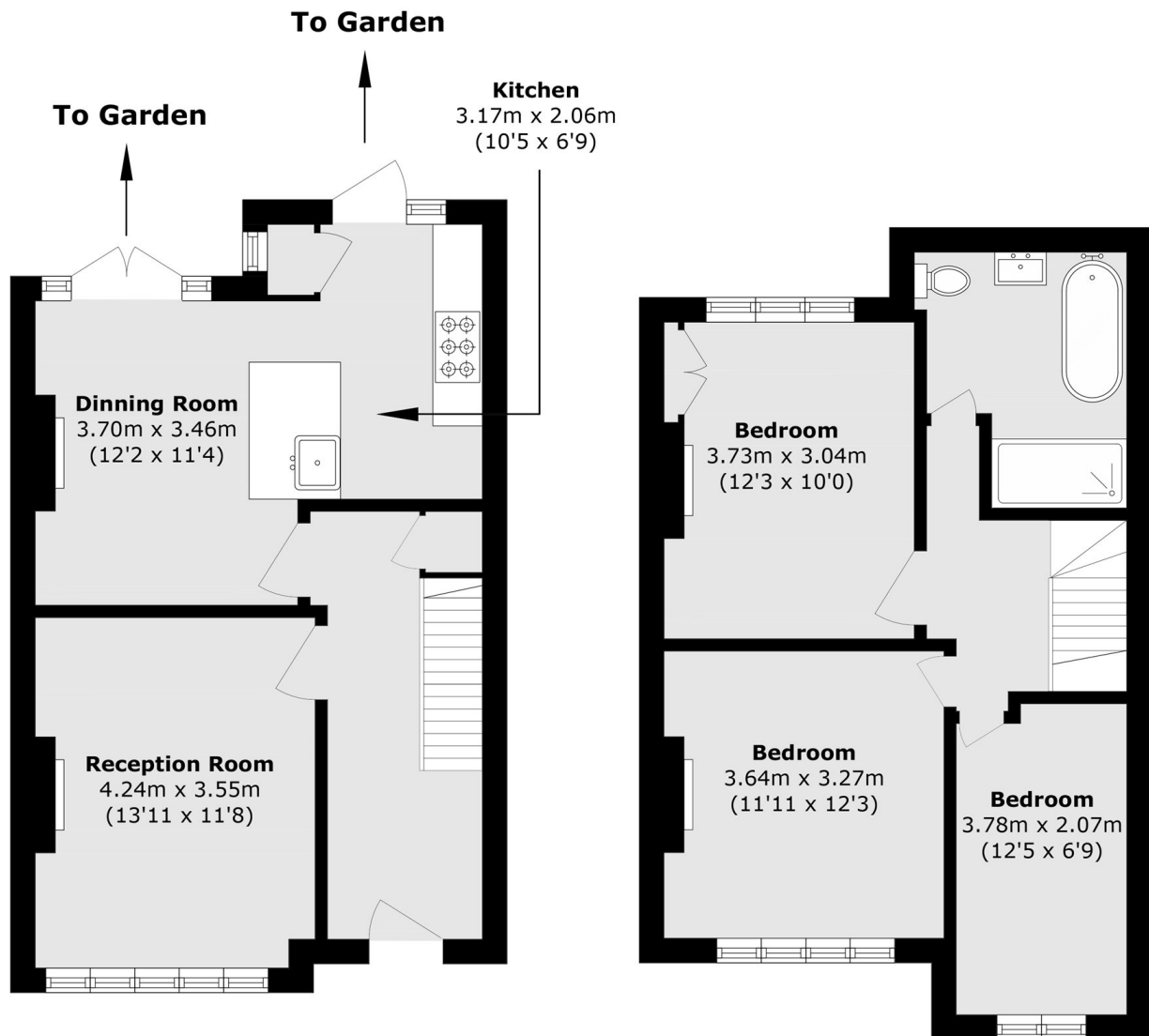

Ground Floor

First Floor

Total area (approx.): 91.2 sq. m (981.6 sq. ft)