



Eastdown Park, SE13
£375,000

Dexters



Eastdown Park, SE13

A bright and well-proportioned hall floor flat located on Eastdown Park, SE13, offering excellent access to local amenities and transport links. The property comprises a spacious double bedroom, a generous lounge, a separate kitchen, and a bathroom. Additional benefits include a private rear garden, off-road parking, share of freehold, and no upward chain, making this an ideal purchase for first-time buyers or investors.

Just a short walk to Lewisham High Street with its vibrant market, shops, and restaurants, plus excellent transport links via Lewisham Station and Ladywell Station. Hither Green is also nearby. Enjoy nearby green spaces, including Hilly Fields, Mountsfield Park, Ladywell Fields, Blackheath, and Greenwich Park, along with Manor Park and Manor Park Gardens for relaxing walks.

Features

- Hall Floor Apartment
- Share Of Freehold
- One Double Bedroom
- No Upward Chain
- Private Rear Garden
- Off Road Parking



Eastdown Park, LONDON, SE13

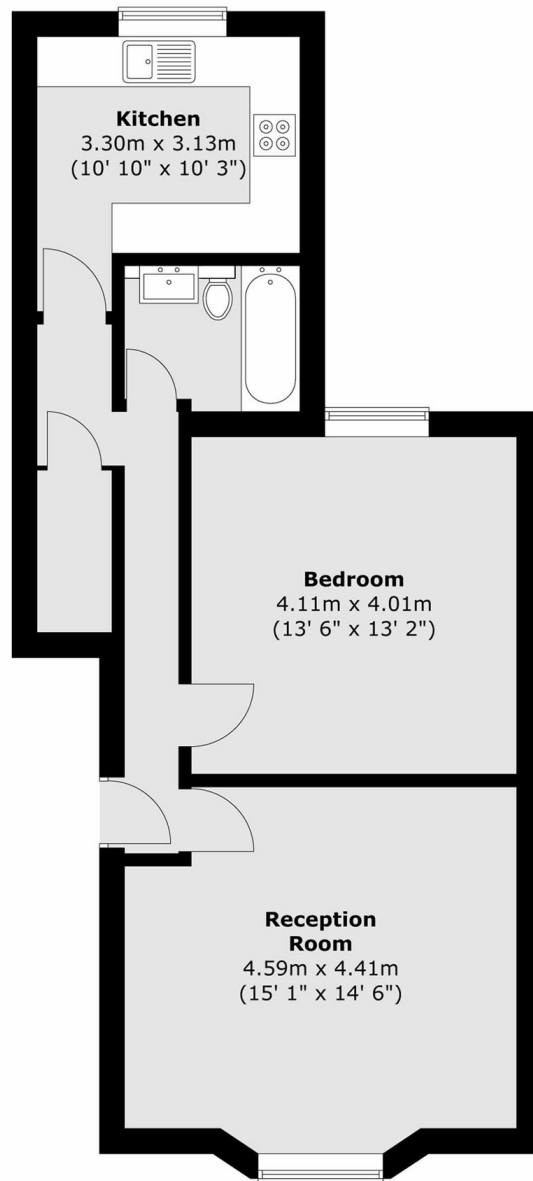

Total area (approx.) : 57.3 sq. m (617 sq. ft)