



Hunsdon Road, SE14

£3,300 Per calendar month

A recently redecorated five double bedroom HMO. Including modern features, two bathrooms and a private rear garden.

Hunsdon Road is situated in the popular Hatcham Park Conservation Area close to the desirable Monson School and also within easy reach of a range of local amenities including New Cross Gate and Queens Road Peckham Overground Stations and a Sainsbury's.

Features

Victorian House
Five Double Bedrooms
Two Bathrooms
Private Rear Garden
Close To Station
Furnished

Hunsdon Road, London, SE14

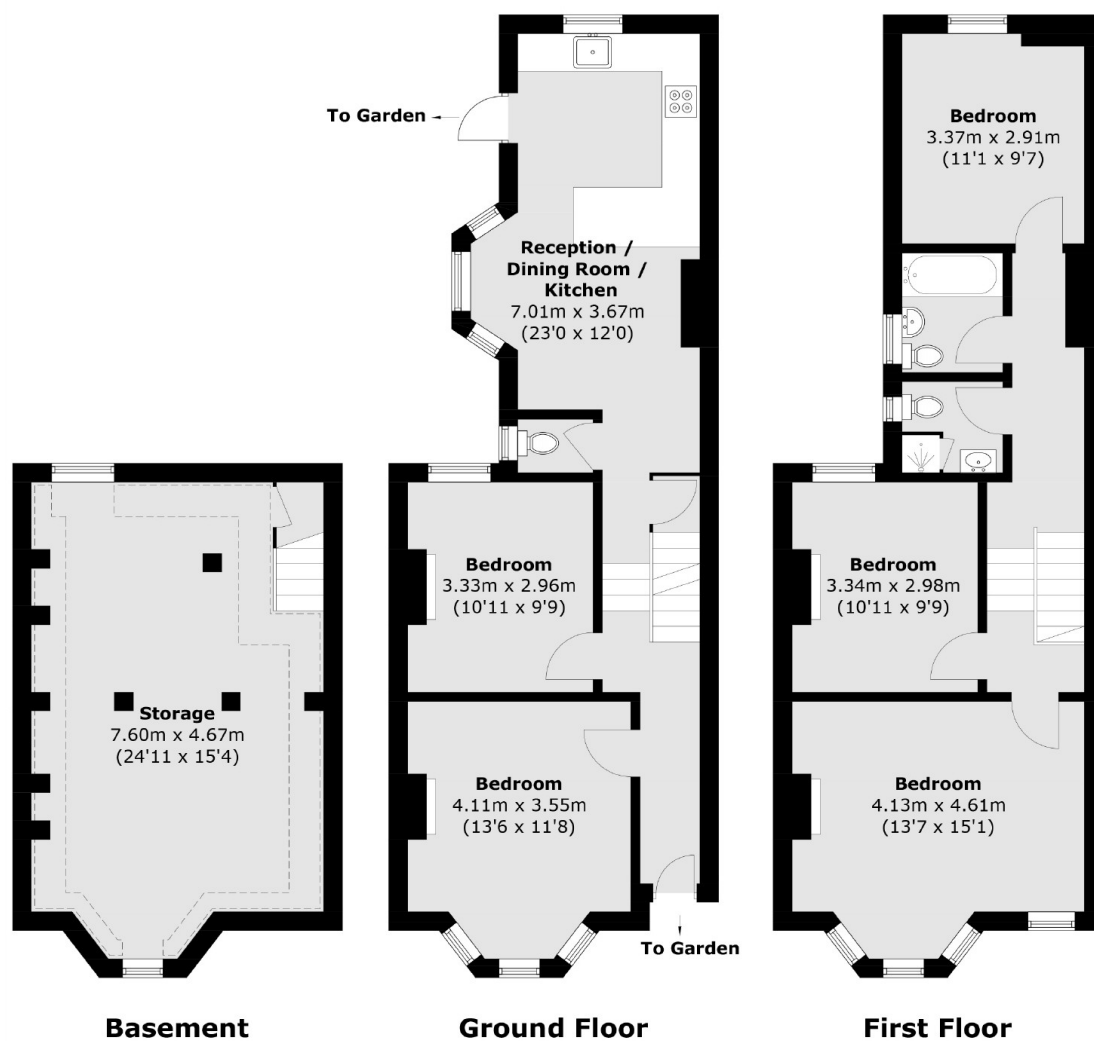

Total area (approx.): 141.7 sq. m (1,525.3 sq. ft)

Dexters

New Cross
256 New Cross Road
London
SE14 5PL
Lettings
020 7313 3661

Energy Rating: . We aim to make our particulars both accurate and reliable. However they are not guaranteed; nor do they form part of an offer or contract. If you require clarification on any points then please contact us, especially if you're traveling some distance to view. Please note that appliances and heating systems have not been tested and therefore no warranties can be given as to their good working order.

 **RICS** | Regulated
Estate Agent
and Letting Agent

[dexters.co.uk](https://www.dexters.co.uk)