



Erlanger Road, SE14

£1,650 Per calendar month

A fantastic one double bedroom ground floor Victorian Conversion flat. Located in the sought after Telegraph Hill Conservation area including an open plan kitchen/ living room, modern bathroom and a stone's throw from Telegraph Hill Park.

The property is a short 0.4 miles from New Cross Gate station making a commute into zone one under ten minutes and 0.7 miles from Queens Road Peckham overground station.

As well as great train links you are 0.1 miles from New Cross bus station connecting you with the whole of London.

Features

Telegraph Hill
Open Plan
Courtyard
Furnished
Close to station

Erlanger Road, London, SE14

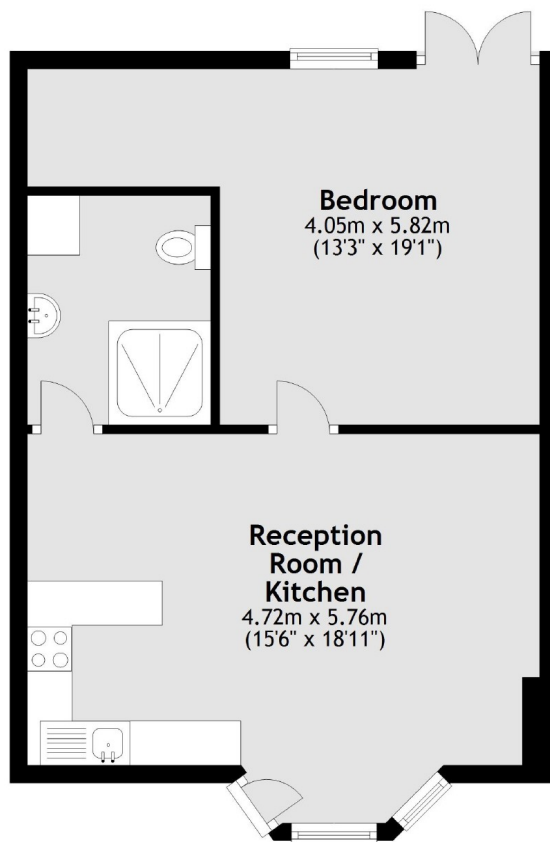

Total area: approx. 47.2 sq. metres (507.9 sq. feet)