



Pomeroy Street, SE14

£400,000

Guide Price £400,000 - £425,000. A spectacular top floor modern apartment. This property benefits from being in stunning condition and has a large terrace spanning the length of the apartment with floor to ceiling windows giving an abundance of natural light. There are fitted appliances and stunning views West facing across London

Features

- One Bedroom
- Great Location
- Over 550 sq Ft
- Great Transport
- Apartment Spanning Terrace
- Bike Storage



Pomeroy Street, SE14

Pomeroy Street is ideally located for both Queens Road Peckham and New Cross Gate Overground stations. The boutique shops, restaurants and cafe's of Queens Road and Peckham are also within a short distance.



Pomeroy Street, London, SE14

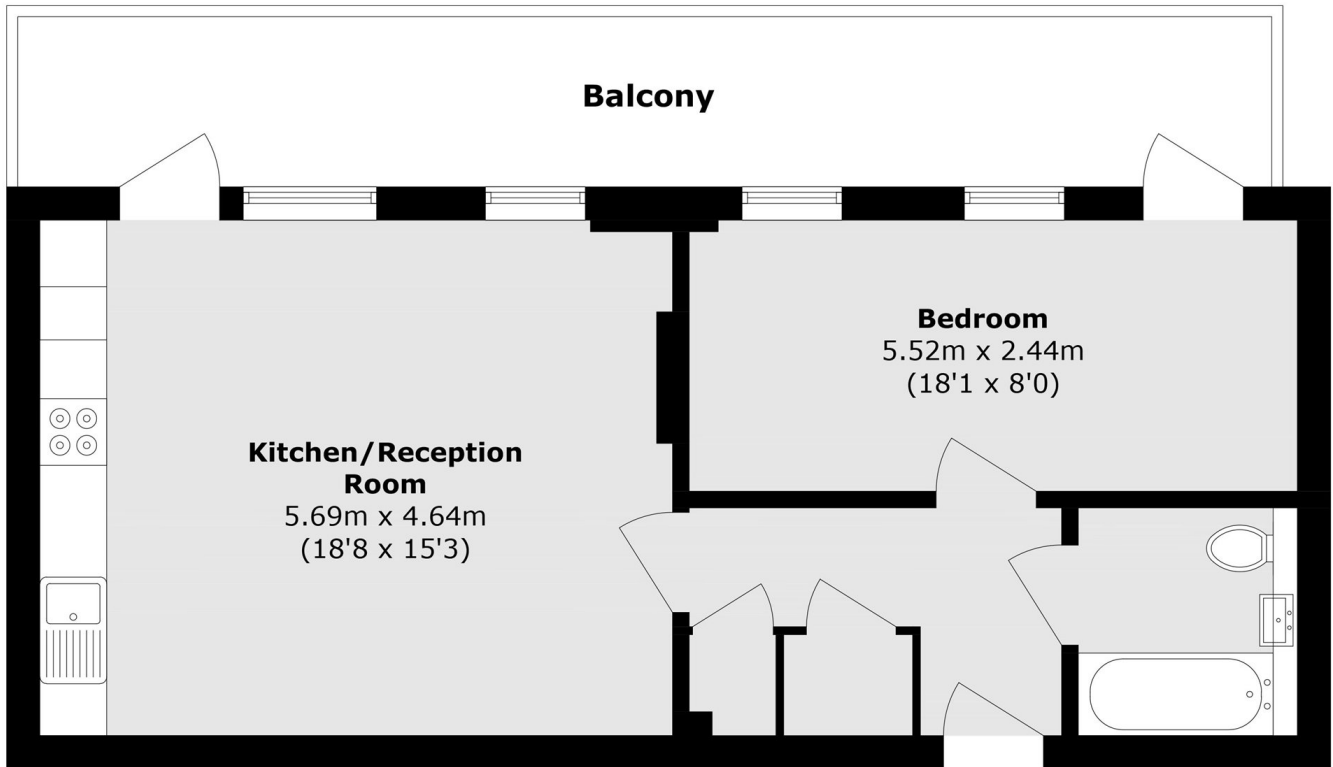

Total area (approx.): 52.4 sq. m (564.0 sq. ft)

Balcony area (approx.): 17.2 sq. m (185.1 sq. ft)