



## Highwood Close, SE22

### £300,000

Set within a well kept purpose built development, this ground floor one bedroom apartment offers bright well proportioned interiors and a highly convenient location close to Forest Hill and the green open spaces surrounding Dulwich.

Epping Court benefits from a peaceful residential setting while remaining moments from excellent transport links. Forest Hill station offers London Overground and National Rail services connecting quickly to Canada Water Shoreditch London Bridge and beyond. Horniman Museum and Gardens is just on your doorstep and the Lordship Lane shops make this location ideal for an upbeat and lively lifestyle.

### Features

- One Bedroom Apartment
- Chain Free
- Off Street Parking Available
- Close To Forest Hill Station
- Horniman Gardens Nearby
- Ideal For First Time Buyers

# Highwood Close, London, SE22

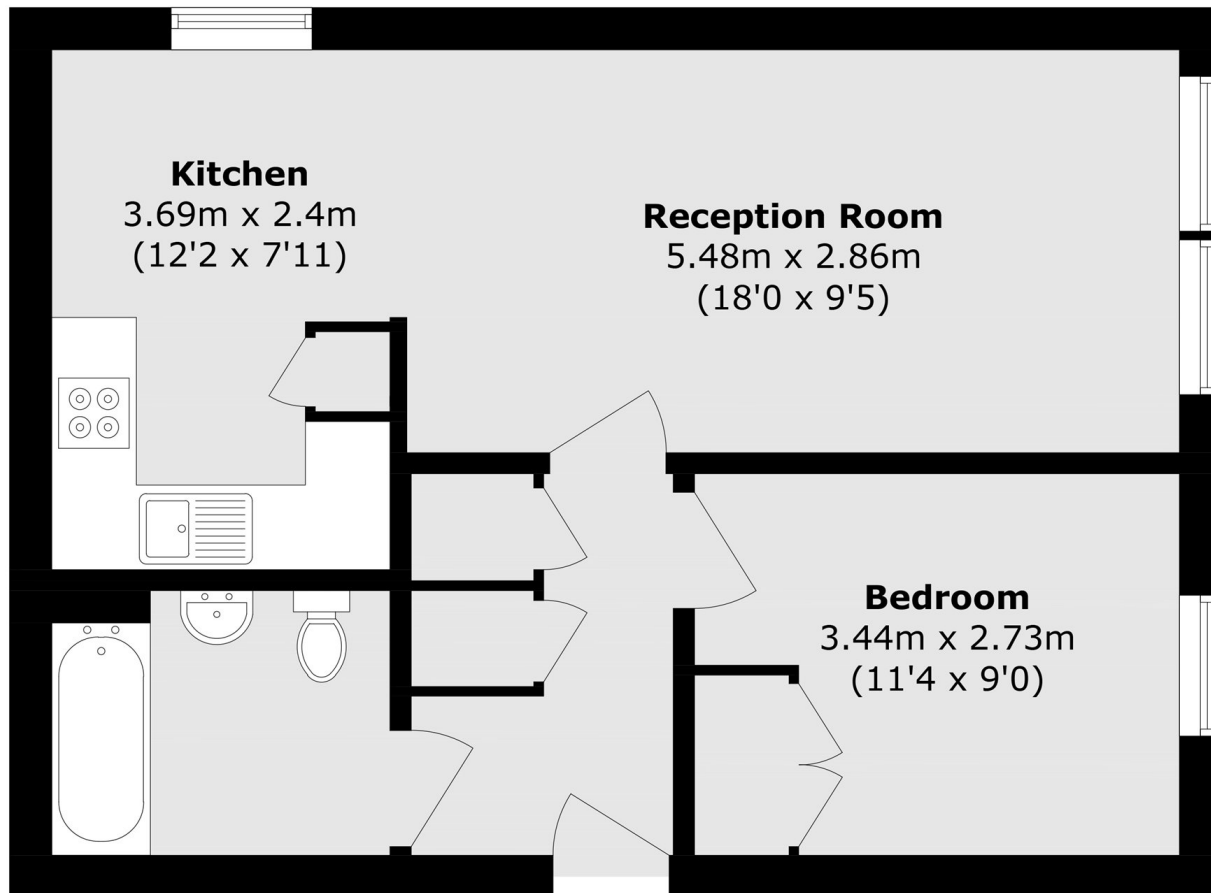

Total area (approx.): 45.8 sq. m (492.6 sq. ft)