



Camberwell Grove, SE5

£795,000

Dexters



Camberwell Grove, SE5

A substantial three bedroom penthouse within Mary Datchelor House, one of Camberwell's most distinguished school conversions, with underground parking, two landscaped courtyards, premium award winning management and a remarkable south west facing balcony with far reaching views across London.

Arranged across approximately 1,076 sq ft, this impressive penthouse centres on an impressive open plan reception room and kitchen, with full height glazing opening directly onto the balcony. The kitchen is contemporary and well integrated, with clean lines, generous storage and a refined finish.

The principal bedroom is well proportioned and served by an en suite shower room, while two further bedrooms offer excellent flexibility for guests, children or home working. A separate family bathroom completes the accommodation.

The balcony is a defining feature, running across the apartment and enjoying a desirable south west aspect over rooftops, mature greenery and the London skyline.

Camberwell Grove is one of the area's most admired addresses, close to Camberwell, Denmark Hill, Peckham and East Dulwich, with excellent transport links from Denmark Hill station.

Features

- Landmark School Conversion
- Three Bedroom Penthouse
- Two Bathrooms
- South-West Facing Balcony
- 1.076 Square Foot
- Underground Parking







Camberwell Grove, London, SE5

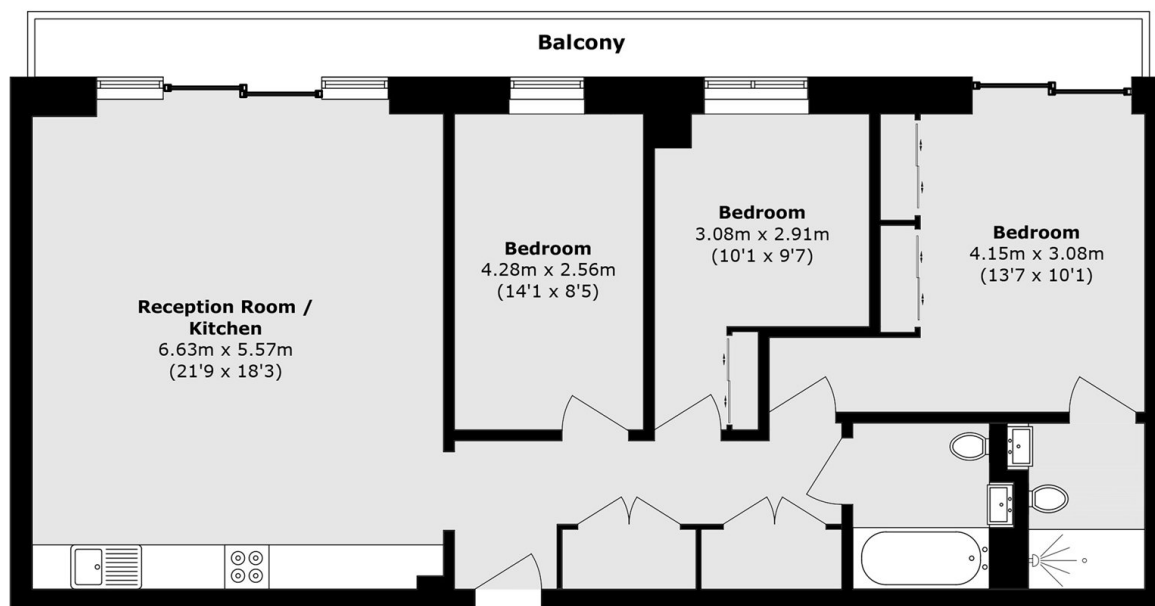

Total area (approx.): 100.0 sq. m (1076.4 sq. ft)

Balcony area (approx.): 11.8 sq. m (127.0 sq. ft)