



Bardsley Lane, SE10

£525,000

A beautifully presented two bedroom, two-bathroom apartment ideally located in the heart of Greenwich. Boasting a spacious open-plan living and dining area, with direct access to a generous South-East facing balcony. Additional features include ample integrated storage, offering both style and functionality.

Located in the heart of Greenwich for independent shops, bars and restaurants, Greenwich Mainline and DLR Station is a short walk away providing direct connections to Canary Wharf, Bank, London Bridge, Cannon Street and Kings Cross. While the Greenwich Park and Greenwich Market are both within easy reach.

Features

- Two Bedrooms
- Two Bathrooms
- Ideal First Purchase
- Modern
- Sought After Location
- Private Balcony

Bardsley Lane,
London, SE10

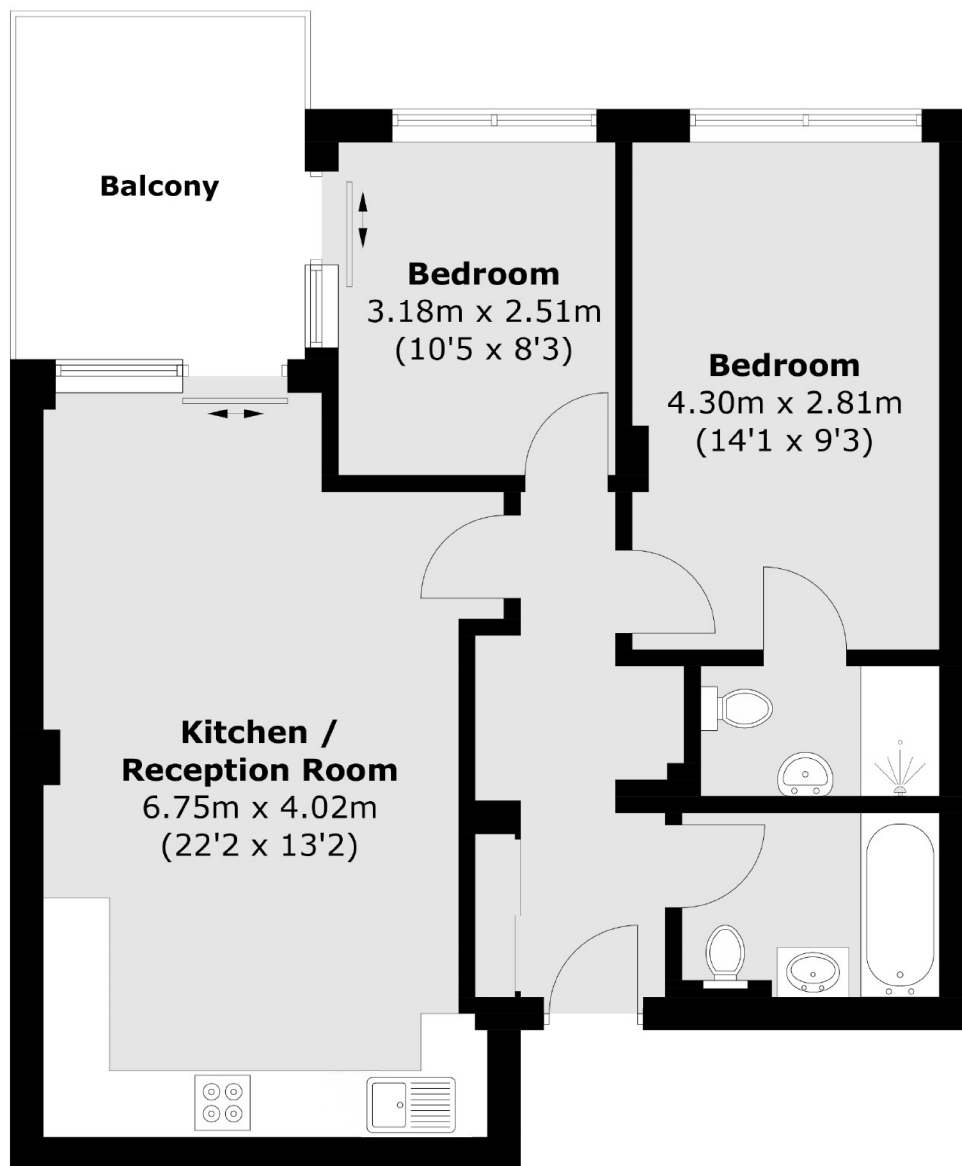

Total area (approx.): 62.3 sq. m (670.6 sq. ft)
Balcony: 8.1 sq. m (87.2 sq. ft)

Dexters

Greenwich
275 Greenwich High Road
Greenwich
London
Sales
020 8815 2215

Energy Rating: B. We aim to make our particulars both accurate and reliable. However they are not guaranteed; nor do they form part of an offer or contract. If you require clarification on any points then please contact us, especially if you're traveling some distance to view. Please note that appliances and heating systems have not been tested and therefore no warranties can be given as to their good working order.

RICS | Regulated
Estate Agent
and Letting Agent

dexters.co.uk