



## Old Woolwich Road, SE10

### £625,000

A newly renovated split level period conversion flat with three bedrooms, one bathroom and an additional W.C. This property has been finished to a high standard and is situated in a sought after location. The property further benefits from owning a share of the freehold and has a HMO licence.

Old Woolwich road is ideally situated close to many local amenities in the historic centre of Greenwich with Greenwich Park moments away. Public transport links include Cutty Sark DLR Station and Maze Hill National Rail Station.

### Features

- Period Conversion
- Three/ Four Bedrooms
- Chain Free
- Newly Renovated
- Share Of Freehold
- Sought After Location

# Old Woolwich Road, London, SE10

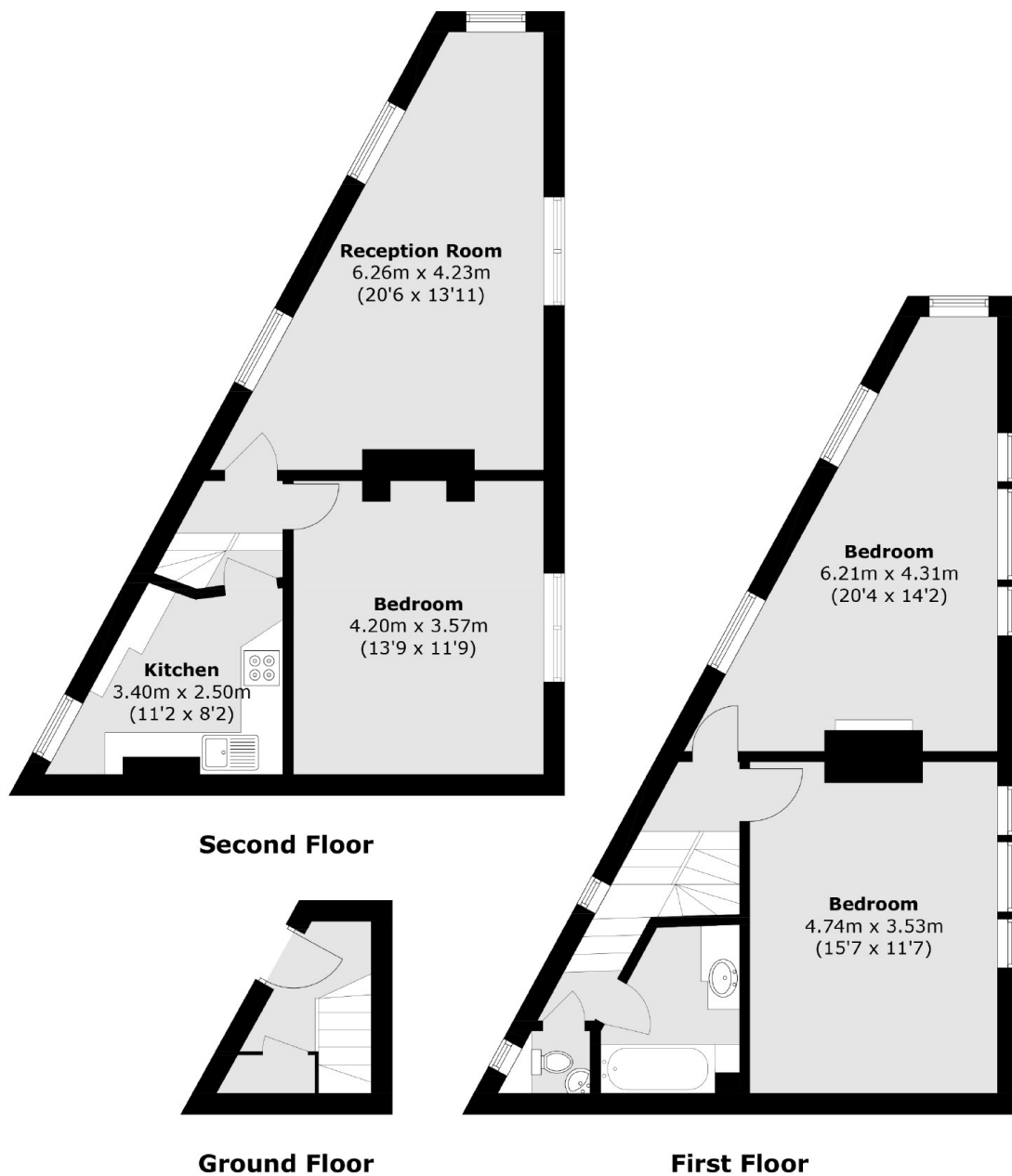

Total area (approx.): 94.6 sq. m (1,018.3 sq. ft)

## Dexters

Greenwich  
275 Greenwich High Road  
Greenwich  
London  
Sales  
020 8815 2215

Energy Rating: D. We aim to make our particulars both accurate and reliable. However they are not guaranteed; nor do they form part of an offer or contract. If you require clarification on any points then please contact us, especially if you're traveling some distance to view. Please note that appliances and heating systems have not been tested and therefore no warranties can be given as to their good working order.

 **RICS** | Regulated  
Estate Agent  
and Letting Agent

[dexters.co.uk](https://www.dexters.co.uk)