



Bessemer Place, SE10

£550,000

Bright and spacious two double bedroom apartment located within the highly desirable Platinum Riverside development, North Greenwich. The property benefits from having private outdoor space and gated off street parking, as well as a residents gym and concierge.

Greenwich Peninsula is a modern community that has been designed with the residents in mind offering a range of amenities, which include North Greenwich Station for direct connections to Canary Wharf, London Bridge and The West End. The o2 arena which offers an array of bars and restaurants to enjoy as well as a cinema and retail outlet centre.

Features

- Two Double Bedrooms
- Private Balcony
- Off Street Parking
- Concierge And Residents Gym
- Modern Development
- Soughtafter Location

Bessemer Place, London, SE10

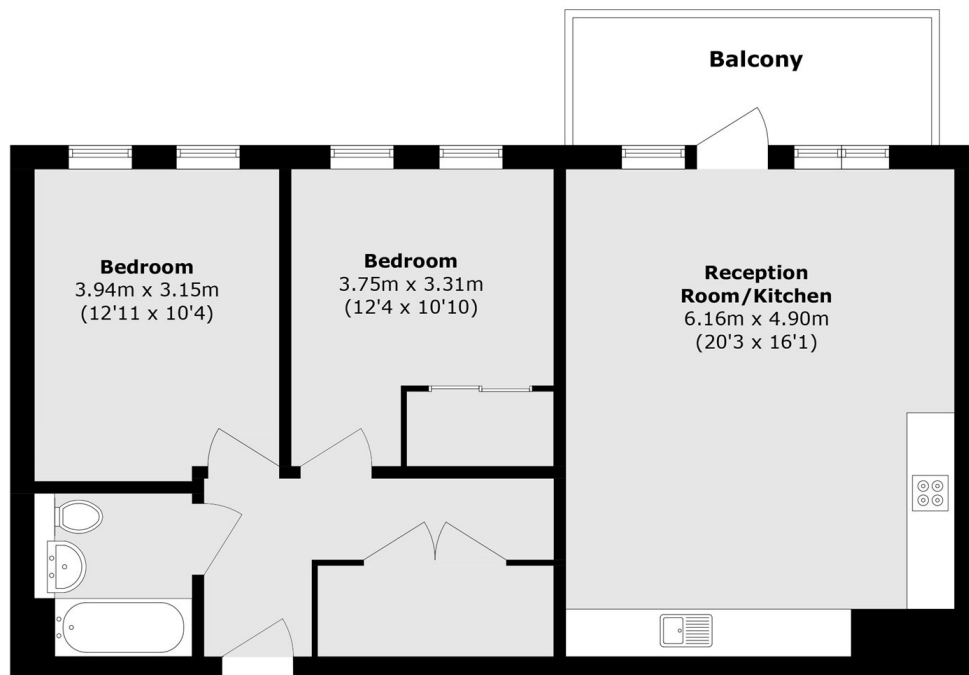

Total area (approx.): 71.3 sq. m (767.4sq. ft)

Balcony area (approx.): 7.2 sq. m (77.5 sq. ft)