



**Various Units**  
**Kings Hill Industrial Estate, Bude EX23 8QN**

**POA - LEASEHOLD**

**Miller Commercial**   
Chartered Surveyors and Business Property Specialists

## SUMMARY

- **VARIOUS SIZED UNITS AVAILABLE**
- **SCREWFIX, DULUX AND TOOLSTATION IN SITU**
- **FULLY REFURBISHED**
- **MAIN ROAD FRONTAGE**

## LOCATION

Kings Hill Industrial Estate is situated on the A3073, on the outskirts of Bude.

Kings Hill Industrial Estate is the principal trading estate for miles around.

The town lies alongside the main A39 Atlantic Highway which leads to Newquay and its airport which is approximately 45 minute drive away.

In the opposite direction, the major North Devon towns of Bideford and Barnstaple are within easy reach, linking to the North Devon link road which provides access to the M5 Bristol and beyond.



## DESCRIPTION

Bude Self Storage Business Centre offers flexible, commercial space and a main roadside prominence at the front of Kings Hill.

Recently refurbished and finished to a high specification with brand-new utilities, screed floors, elevations and roof.

Ideally located at the entrance of the industrial estate.

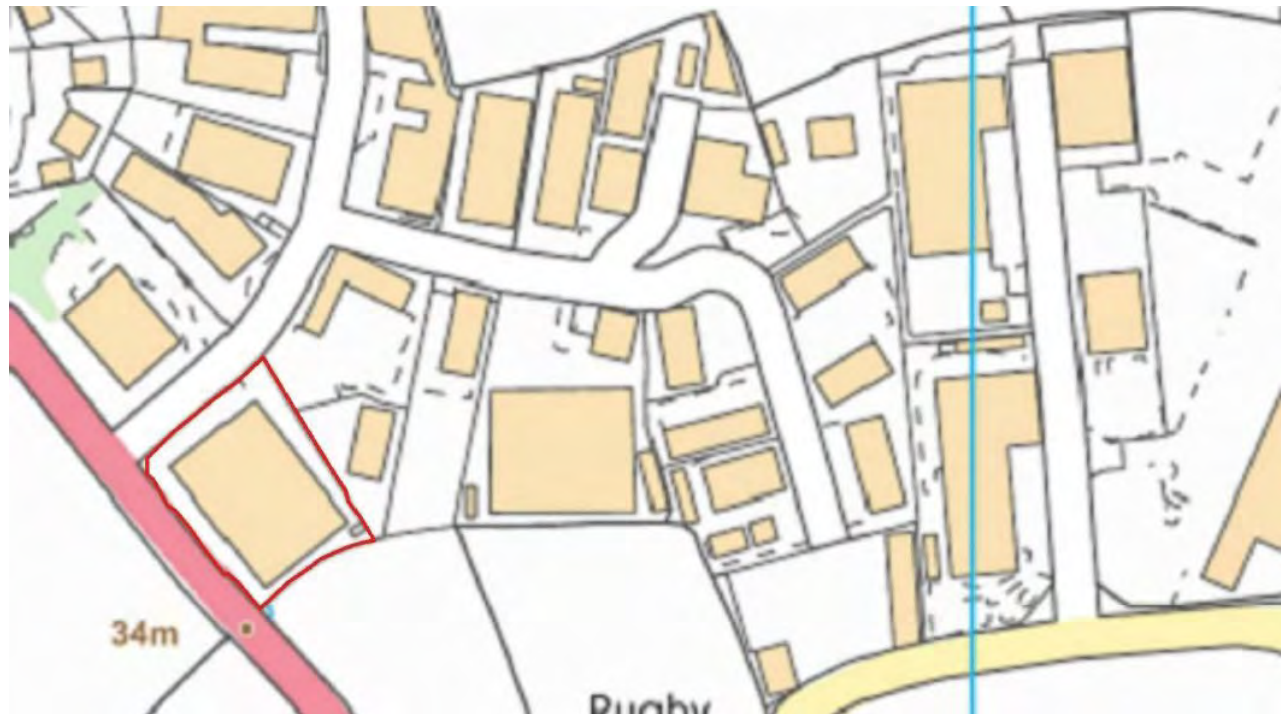

## ACCOMMODATION

- Unit 1 - Let to Screwfix - 4300 sq ft
- Unit 2 - Let to Dulux - 4300 sq ft
- Unit 3 - Let to Toolstation - 4300 sq ft
- Unit 4 - 7 - Any size or configuration considered.

Designated and communal car parking available.

## TERMS

A new lease is offered with the tenant to be responsible for internal repair and a contribution towards insurance. The tenant will also contribute to all the communal costs by way of a service charge.

Rent: From £9.50 Per sq ft

## LOCAL AUTHORITY

### Cornwall Council

- General Enquiries: **0300-1234-100**
- Planning: **0300-1234-151**
- [www.cornwall.gov.uk](http://www.cornwall.gov.uk)

## BUSINESS RATES

We refer you to the government website:

<https://www.tax.service.gov.uk/view-my-valuation/search>

however, the rateable value for this unit has yet to be determined.

## SERVICES

Prospective owners should make their own enquiries of the appropriate statutory undertakers:

- Western Power: **0845 601 2989**
- South West Water: **0800 169 1144**
- Transco: **0800 111 999**

## VALUE ADDED TAX

All the above prices/rentals are quoted exclusive of VAT, where applicable.

## ENERGY PERFORMANCE CERTIFICATE

The Energy Performance Rating for this property is within Band C.

## CONTACT DETAILS

For further information or an appointment to view please contact either:

**Peter Heather** on **01872 247007** or via email [pgh@miller-commercial.co.uk](mailto:pgh@miller-commercial.co.uk) or  
**Tom Smith** on **01872 247013** or via email [ts@miller-commercial.co.uk](mailto:ts@miller-commercial.co.uk) or  
**Thomas Hewitt** on **01872 247025** or via email [th@miller-commercial.co.uk](mailto:th@miller-commercial.co.uk)



**AGENTS NOTE:** Miller Commercial for themselves and for the Vendor/s or lessor/s of this property give notice: **[a]** These particulars are for an intending purchaser or tenant and although they are believed to be correct their accuracy is not guaranteed and any error or misdescriptions shall not annul the sale or be grounds on which compensation may be claimed and neither do they constitute any part of a Contract: **[b]** No responsibility is taken for expenses incurred should the property be sold, let or withdrawn before inspection: **[c]** None of the services or appliances, plumbing, heating or electrical installations have been tested by the selling agent.

Miller Commercial is the trading name of Miller Commercial LLP registered in England and Wales under Registration No.OC373087. The Registered Office of Miller Commercial LLP is Mansion House, Princes Street, Truro TR1 2RF. We use the term Partner to refer to a member of Miller Commercial LLP. VAT Registration No.643 4519 39.

# Kings Hill Industrial Estate, Bude, EX23 8QN

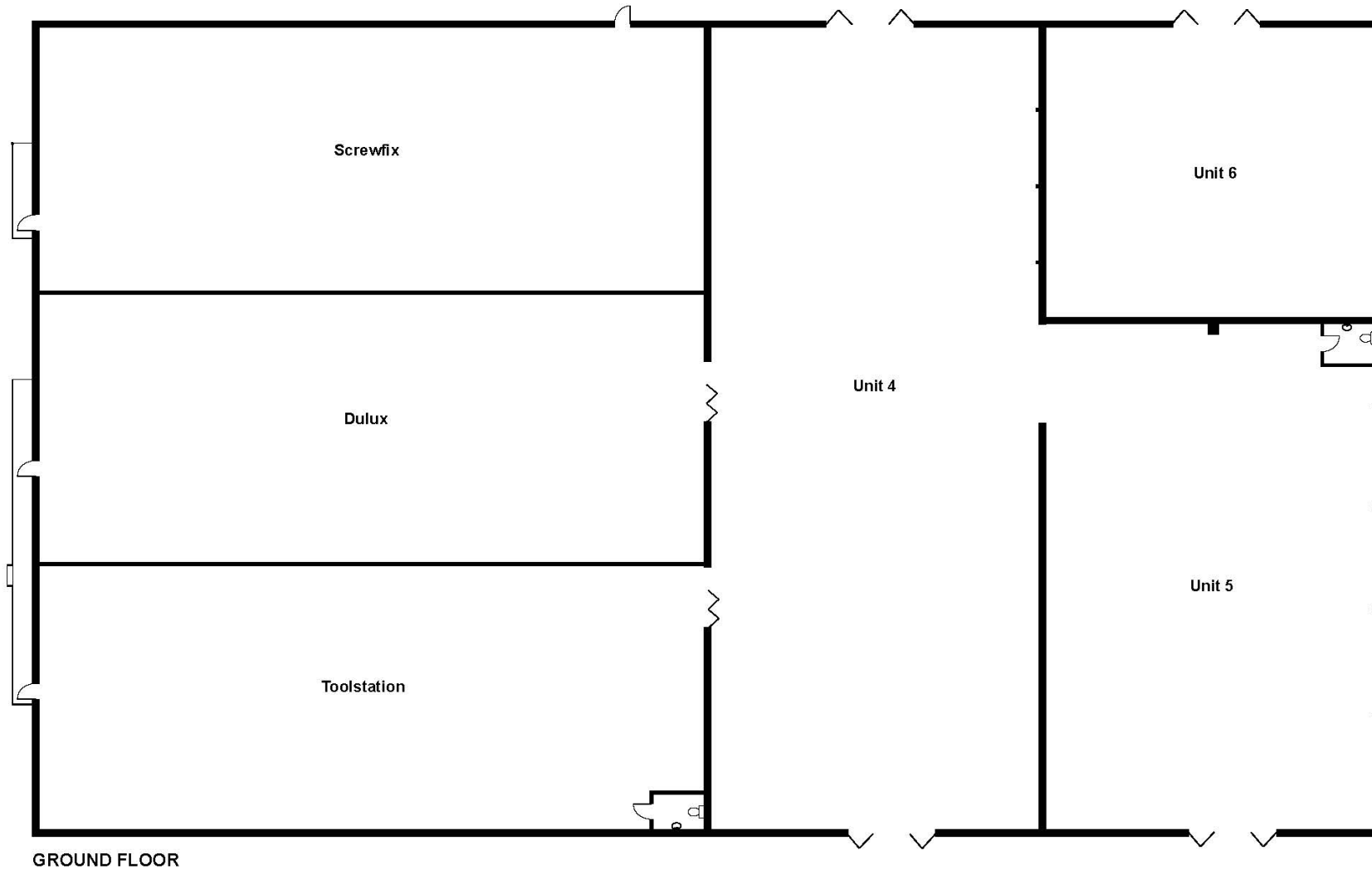
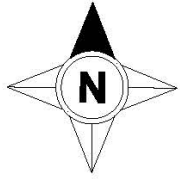

Floor plan produced in accordance with RICS Property Measurement Standards incorporating International Property Measurement Standards (IPMS2 Residential). © nichecom 2021. Produced for Miller Commercial LLP. REF: 706288