



Gateway Mews, E8

£450,000

A one double bedroom mews apartment in central Dalston with two private patios. Located within the sought after development Gateway Mews the property has an open plan kitchen/living room with two sets of French Patio doors leading to the private outside areas, modern bathroom, wooden flooring and a long lease. It is being sold chain free.

The property is within walking distance to the authentic Ridley Road, Broadway Market and many pubs, brasseries and independent shops. Dalston Kingsland, Hackney Downs and Dalston Junction Stations are close by for easy access to Liverpool Street and Central London. Many bus routes are also available on Kingsland Road.

Features

- One Double Bedroom
- Gated Mews
- Long Lease
- Open Plan
- Close to Amenities & Markets
- Two Private Patios
- Chain Free

Gateway Mews, London, E8

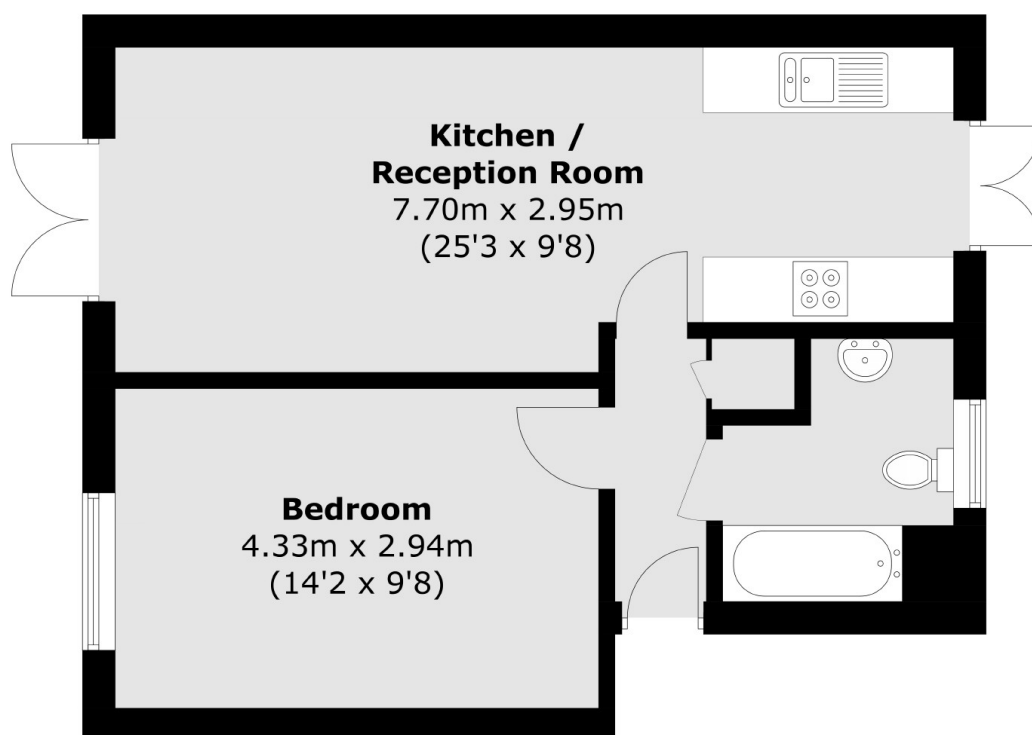

Total area (approx.): 44.1 sq. m (474.6 sq. ft)