



Homerton Road, E9

£400,000

A three bedroom purpose built flat next to Mabley Green, Hackney Marshes and the River Lea. The property has been recently renovated and has a separate kitchen, W/C, double glazed windows and lift access. It has a long lease and is being sold chain free.

Edred House is ideally located next to the green spaces of the Hackney Marshes, the River Lea, Victoria Park and Queen Elizabeth Park offering many outdoor activities. Both Homerton and Hackney Wick Overground Stations are under a mile away for easy access to the rest of London. Chatsworth Road is also within easy reach with its many cafes, shops and Sunday Market.

Features

- Three Bedrooms
- Ideal for Buy-To-Let
- Chain Free
- Separate Kitchen
- Lift Access
- Hackney Marshes

Homerton Road, London, E9

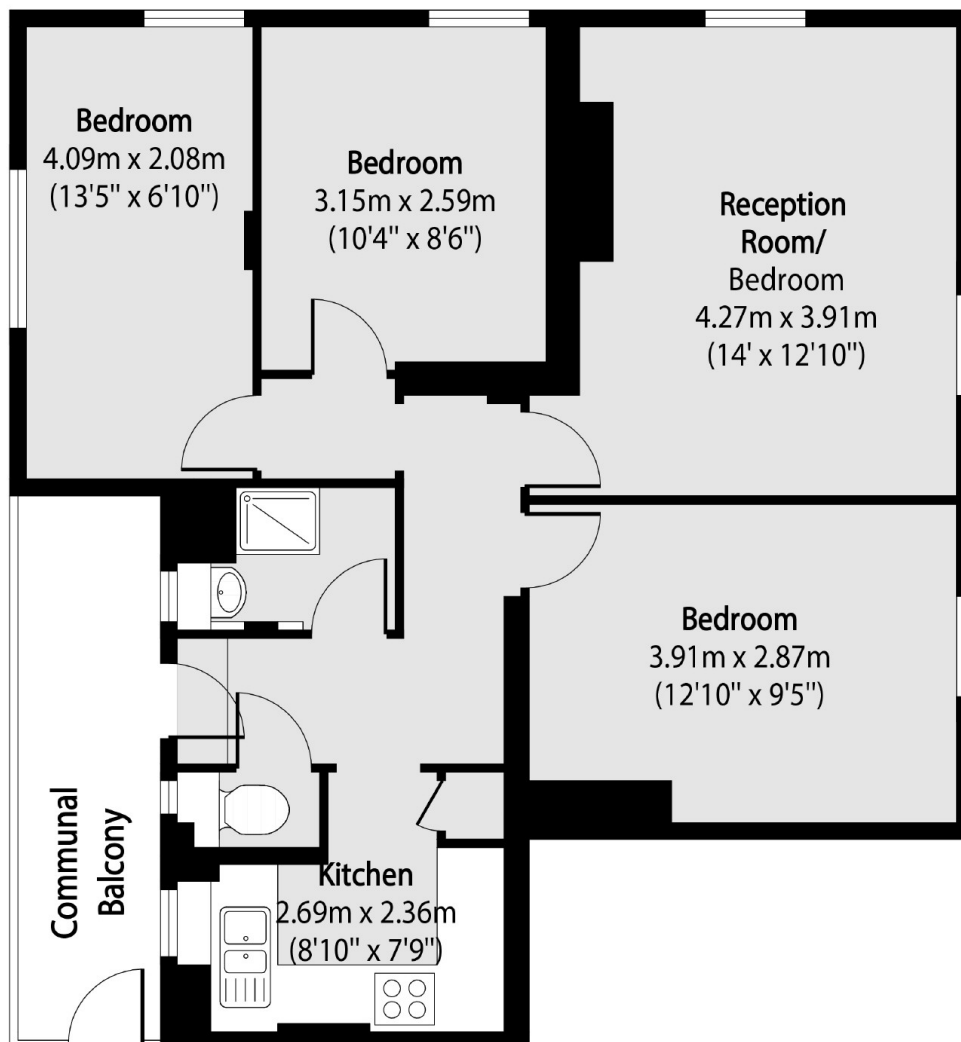

Total area (approx): 62.06 sq m (668 sq. ft)
Communal Balcony total area (approx): 6.41 sq m (69 sq. ft)