



## Sutton Place, E9

### £400,000

A top floor one bedroom apartment within a Georgian terrace in a central location. The property has an open plan kitchen and living area with south facing windows, modern bathroom and spacious bedroom with built in storage. It is being sold with a long lease.

Bay House is situated on a quiet residential street next to St John's Hackney Church and its idyllic gardens. The property is under half a mile from Hackney Central and Hackney Downs Overground Stations offering direct trains to Liverpool Street, Stratford and Highbury & Islington. The many restaurants, cafes and shops of Mare Street, Chatsworth Road & Broadway Market are within walking distance.

### Features

- Georgian
- Top Floor
- One Double Bedroom
- Sash Windows
- Long Lease
- Modern Bathroom

# Sutton Place, London, E9

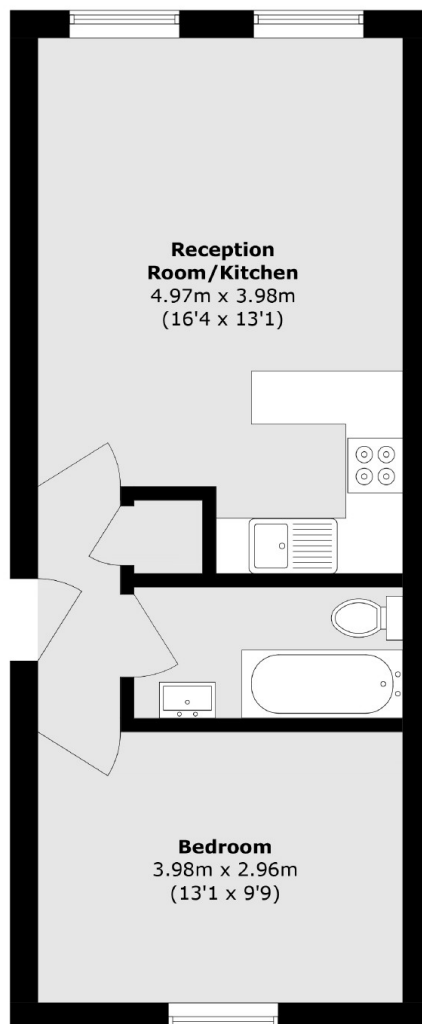

Total area (approx.): 41.9 sq. m (451.0 sq. ft)