

## Richmond Road, E8

### £400,000

A one double bedroom top floor apartment in the sought after development Arthaus Apartments, designed by Lynas Smith Architects. This property has been renovated throughout by its current owners and has underfloor heating, 24 hour concierge, open plan living, roof terrace with views of the city and no onward chain.

This property is located a short walk from London Fields and the popular Broadway Market with its endless bars, restaurants and café's. The building is also served by three in-house restaurants including Pophams. Hackney Central, Hackney Downs and London Fields overground stations are both a short walk away.

### Features

- One Double Bedroom
- Renovated Throughout
- Communal Roof Terrace
- Concierge
- Chain Free
- London Fields

# Richmond Road, London, E8

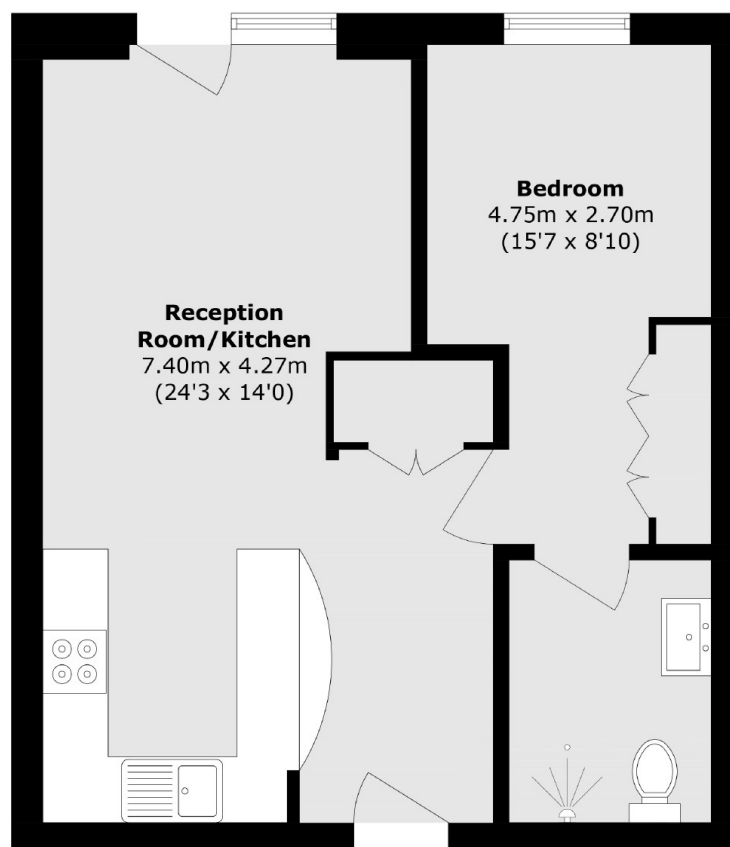

Total area (approx.): 47.0 sq. m (505.9 sq. ft)