



## Dunn Street, E8

### £500,000

Situated within a secure gated development in Dalston, this modern two bedroom flat offers 719 sq ft of well designed living space, including a private patio garden. This ground floor apartment features a spacious open plan kitchen, dining room and living area, two double bedrooms, each with large windows and built-in storage. There is secure bike storage for residents.

Rendles Court is located on a one way street off Shacklewell Lane and around the corner from Kingsland High Street with its diverse selection of independent shops, bars, and restaurants. The property is only a quarter of a mile away from Dalston Kingsland and Dalston Junction Overground Stations, providing excellent links into the City. The green spaces of Hackney Downs Park are within walking distance.

### Features

- Two Double Bedrooms
- Private Patio Garden
- Open Plan
- Built in Storage
- Gated Modern Development
- Close To Transport

# Dunn Street, London, E8

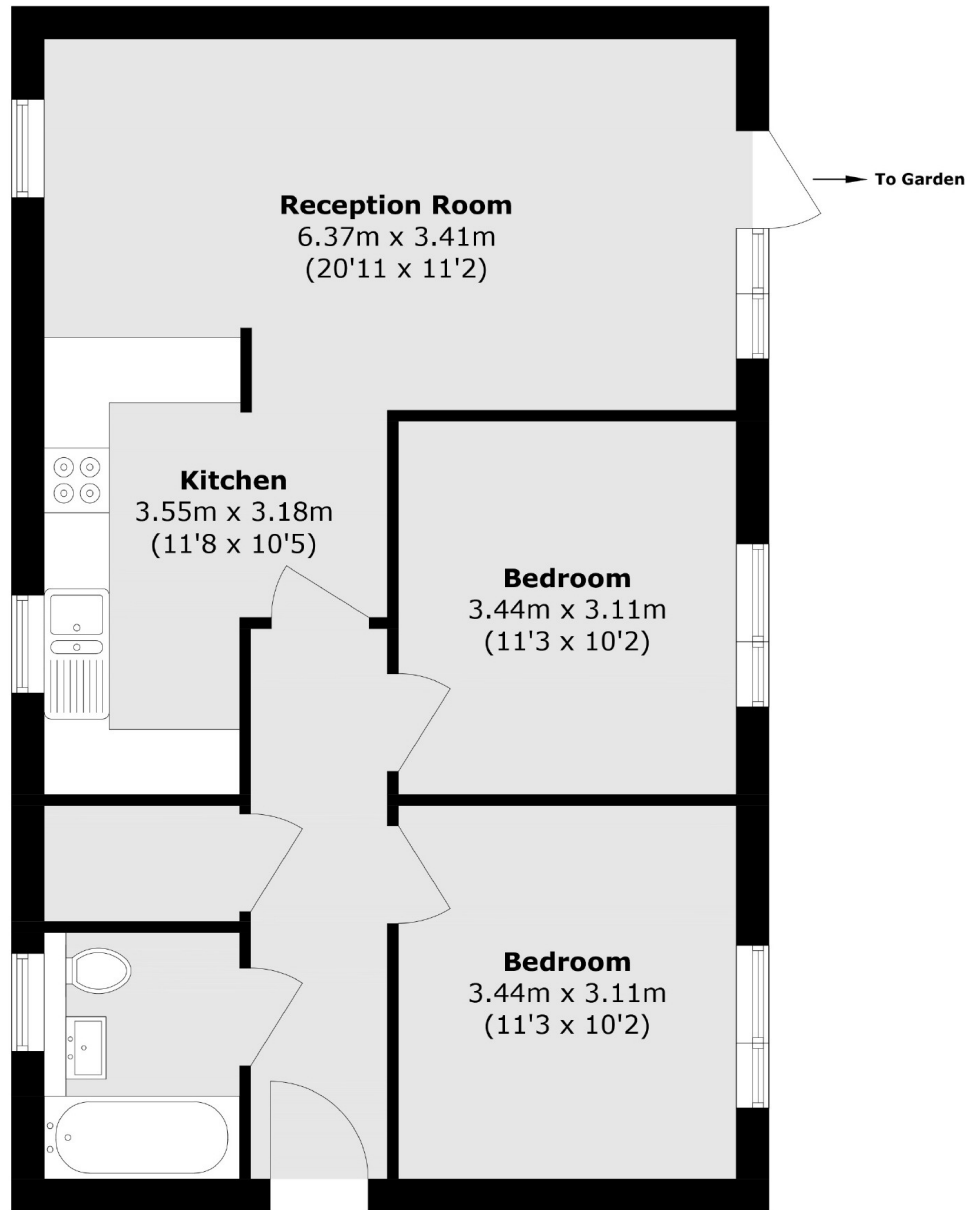

Total area (approx.): 66.8 sq. m (719.0 sq. ft)

## Dexters

Hackney Central  
331 Mare Street  
Hackney  
London  
Sales  
020 7067 2420

Energy Rating: C. We aim to make our particulars both accurate and reliable. However they are not guaranteed; nor do they form part of an offer or contract. If you require clarification on any points then please contact us, especially if you're traveling some distance to view. Please note that appliances and heating systems have not been tested and therefore no warranties can be given as to their good working order.

 **RICS** | Regulated  
Estate Agent  
and Letting Agent

[dexters.co.uk](https://www.dexters.co.uk)