



## Heyworth Road, E5

### £625,000

A two bedroom period conversion with a private south facing garden. Situated on the ground floor within a double fronted Victorian home the property has a spacious living room, two double bedrooms, family bathroom and eat- in kitchen. The property has many original features including wooden floors, bay window with shutters and cornicing. It has a long lease and being sold chain free.

The property is ideally located only 100 yards to Hackney Downs Park offering plenty of space for outdoor recreation including tennis. The many shops, cafés and restaurants of Mare Street, Chatsworth Road and Lower Clapton Road are within walking distance and there are numerous transport links nearby offering easy access into Central and West London being half a mile from Clapton, Hackney Downs & Rectory Road Overground Stations.

### Features

- Victorian Conversion
- Two Double Bedrooms
- Double Fronted
- Chain Free
- Private Garden
- Period Features

# Heyworth Road, London, E5

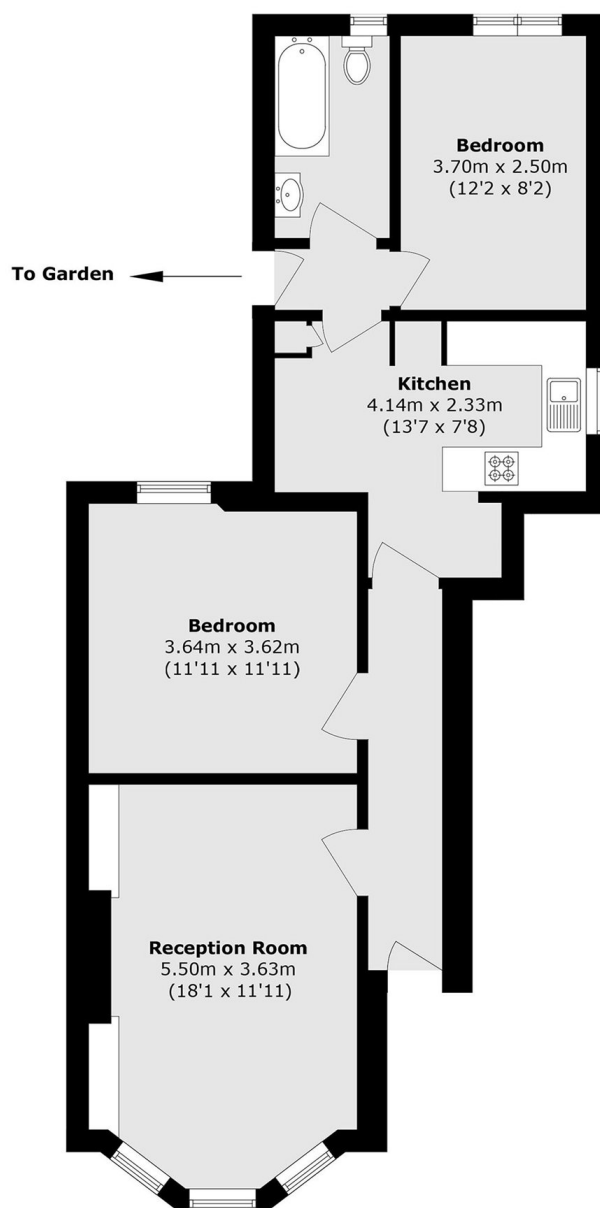

Total area (approx.): 66.9 sq. m (720.1 sq. ft)