



ABBOTS MANOR
PIMLICO

JACKSON-STOPS 

ABBOTS MANOR PIMLICO, SW1V

ASKING PRICE: £634 PER WEEK

A second floor two bedroom maisonette in Pimlico.

Offering two double bedrooms, a study, separate kitchen, reception and a balcony. Heating and hot water included in the rent. Just 0.4 miles from Victoria Station, 0.6 miles from Pimlico Underground Station, 0.6 miles from Sloane Square Underground Station and 0.8 miles from Battersea Park.

KEY FEATURES

- Two Bedrooms
- Study
- Bathroom
- Kitchen
- Reception
- Tax Band: D





Dryburgh House

Approximate Gross Internal Area = 898 sq ft / 83.5 sq m

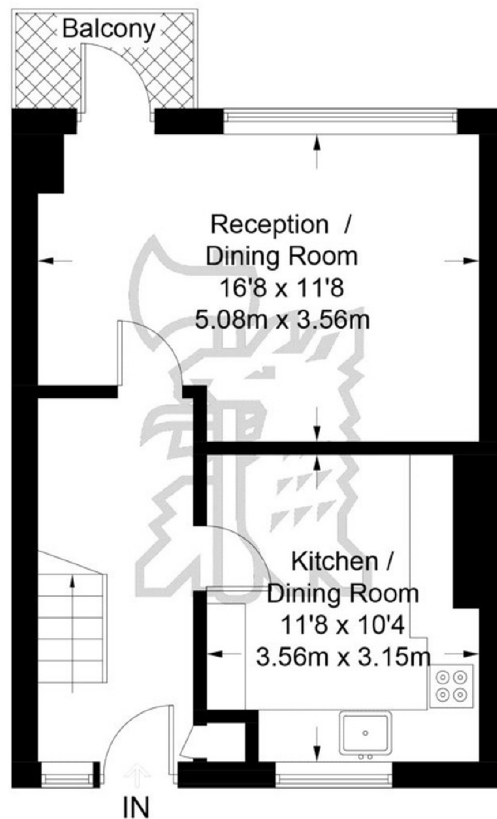

Second Floor = 400 sq ft / 37.2 sq m

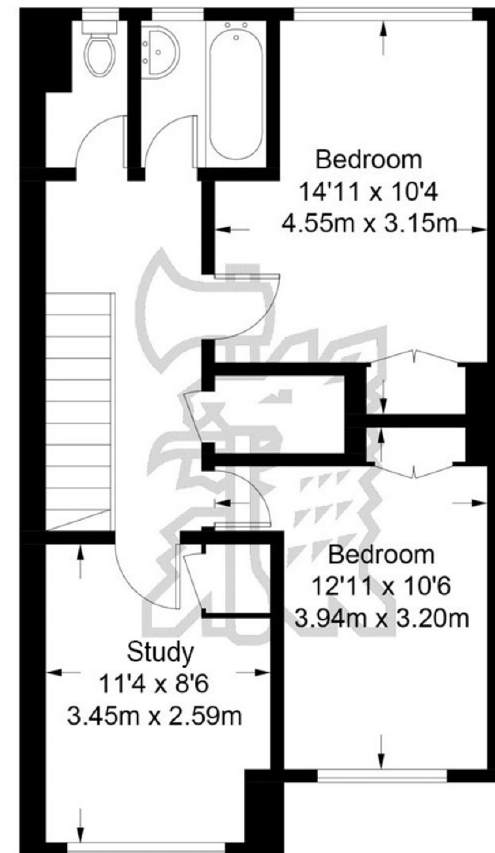

Third Floor = 498 sq ft / 46.3 sq m

Not to scale, for guidance only and must not be relied upon as a statement of fact.
All measurements and areas are approximate only and have been prepared in
accordance with the current edition of the RICS Code of Measuring Practice.

Energy Rating: D. We aim to make our particulars both accurate and reliable. However they are not guaranteed; nor do they form part of an offer or contract. If you require clarification on any points then please contact us, especially if you are travelling some distance to view. Please note that appliances and heating systems have not been tested and therefore no warranties can be given as to their good working order.

ASKING PRICE: £634 PER WEEK

PIMLICO

020 7828 4243

pimlicolettings@jackson-stops.com

jackson-stops.co.uk

JACKSON-STOPS