

Colin Dean Residential

in partnership with Dexters



D'arcy Gardens, HA3

£2,650 pcm

This large three bedroom Terraced house has been recently refurbished throughout. The immaculately presented home offers a spacious reception room, brand-new kitchen with wooden flooring and modern integrated appliances. Upstairs there is a large family sized bathroom with a new bathtub and separate shower enclosure. Energy Rating: C.

The Property is located 1.1 mile from Queensbury Station (Jubilee Line) and 1.2 miles from Kenton Station (Bakerloo Line and Overground). This property has various shops and amenities within close proximity.

- Terraced House • Newly Refurbished • Three Bedrooms •
- Spacious Bathroom • Private Garden • Off Street Parking •

Colin Dean Residential

in partnership with Dexters

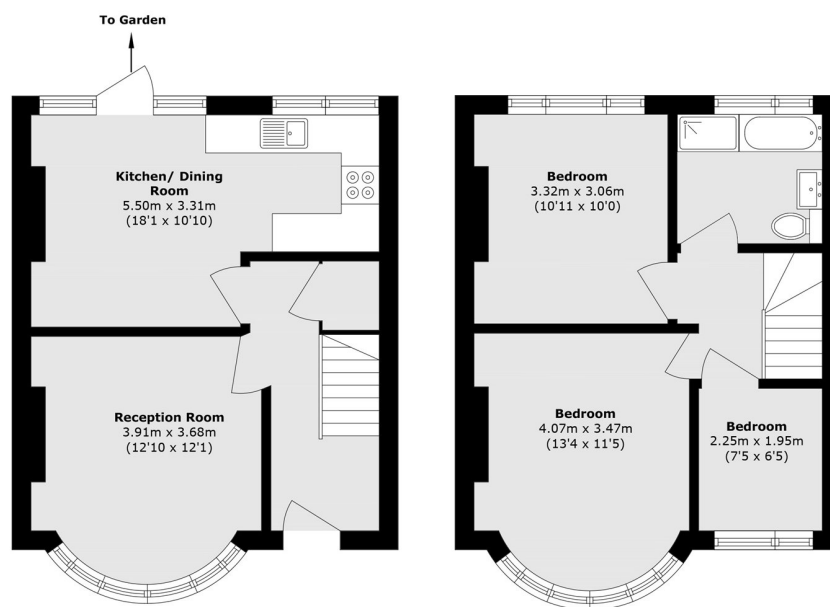

Total area (approx.): 76.0 sq. m (818.1 sq. ft)

Colin Dean Residential
350 Pinner Road,
Harrow, HA1 4LB
020 8515 7929
daniel.murray@colindean.com

Energy Rating: C We aim to make our particulars both accurate and reliable. However they are not guaranteed; nor do they form part of an offer or contract. If you require clarification on any points then please contact us, especially if you're travelling some distance to view. Please note that appliances and heating systems have not been tested and therefore no warranties can be given as to their good working order.