



Grange Road, SE1

£325,000

Moments from Bermondsey Street, this one double bedroom flat is in fantastic condition and boasts a large open plan kitchen living space, modern bathroom, basement for storage and is being sold chain free.

Grange Road is located 0.6 miles from Bermondsey Underground offering excellent transport links to Canary and the rest of London. Maltby Street Market, Bermondsey Street & Shad Thames are all nearby.

Features

- One Double Bedroom
- Chain Free
- Fantastic Location
- Excellent Condition
- Own Private Entrance
- Period Conversion

Grange Road, London, SE1

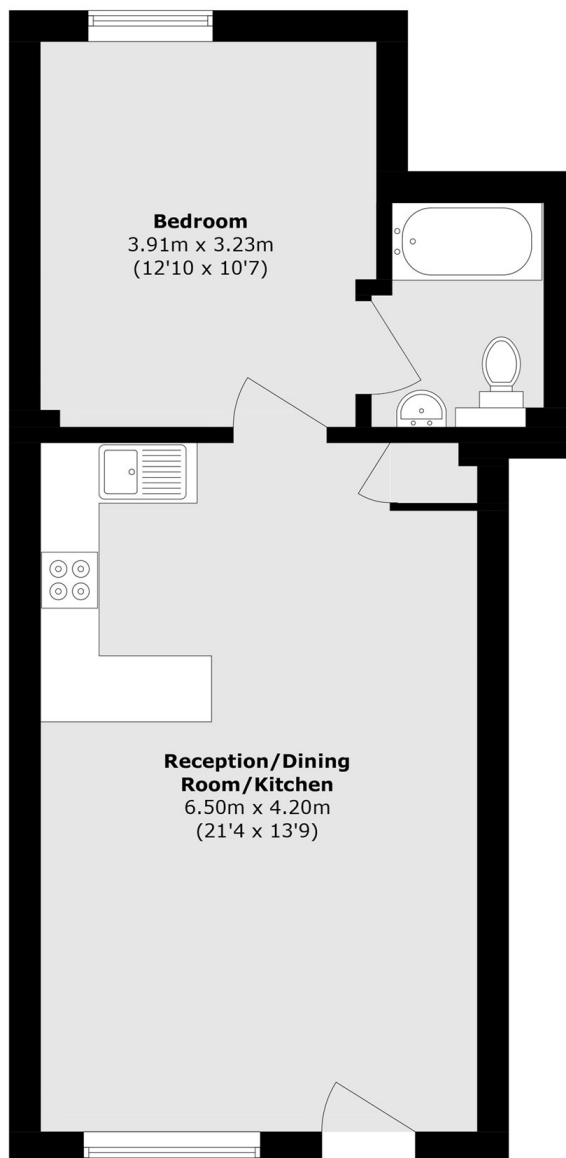

Total area (approx.): 44.0 sq. m (473.6 sq. ft)