



Russell Place, SE16

£438 Per week

A beautifully presented, two double bedroom apartment with beautiful views of Greenland Dock on the top floor of a modern development.

Tavistock is a private development located just moments from the River Thames. Surrey Quays Shopping Centre has numerous retail outlets, and there are good bus and underground links close by.

Features

- Two Double Bedrooms
- Two Bathrooms
- Lots of Storage
- Surrey Quays
- Dock Views
- Furnished

Russell Place, London, SE16

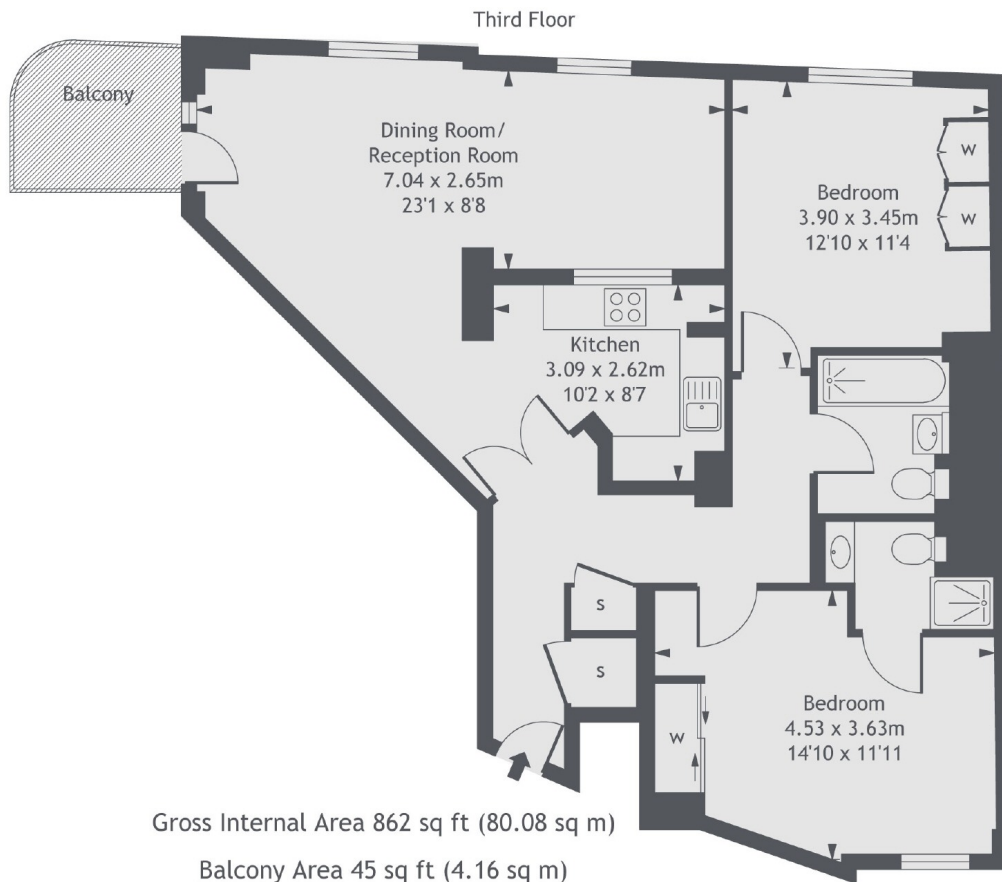

Dexters

Tower Bridge
50 Shad Thames
London
SE1 2LY
Lettings
0207 650 5105

Energy Rating: C. We aim to make our particulars both accurate and reliable. However they are not guaranteed; nor do they form part of an offer or contract. If you require clarification on any points then please contact us, especially if you're traveling some distance to view. Please note that appliances and heating systems have not been tested and therefore no warranties can be given as to their good working order.

 **RICS** | Regulated
Estate Agent
and Letting Agent

[dexters.co.uk](https://www.dexters.co.uk)