



Christian Fields, SW16

£775,000

A spacious, three double bedroom semi-detached family home. Located on a popular tree lined residential road moments from Norbury Park and Norwood Grove.

Christian Fields is one of the most sought after roads in Norbury, lying just 0.6 Miles from Norbury Station. The property is ideal for families as it benefits from easy access to local schools, including state and grammar schools, and the green space of Norbury Park and Norwood Grove.

Features

Semi detached
Three double bedrooms
Through reception room
Southerly aspect garden
Garage
EPC:

Christian Fields, London, SW16

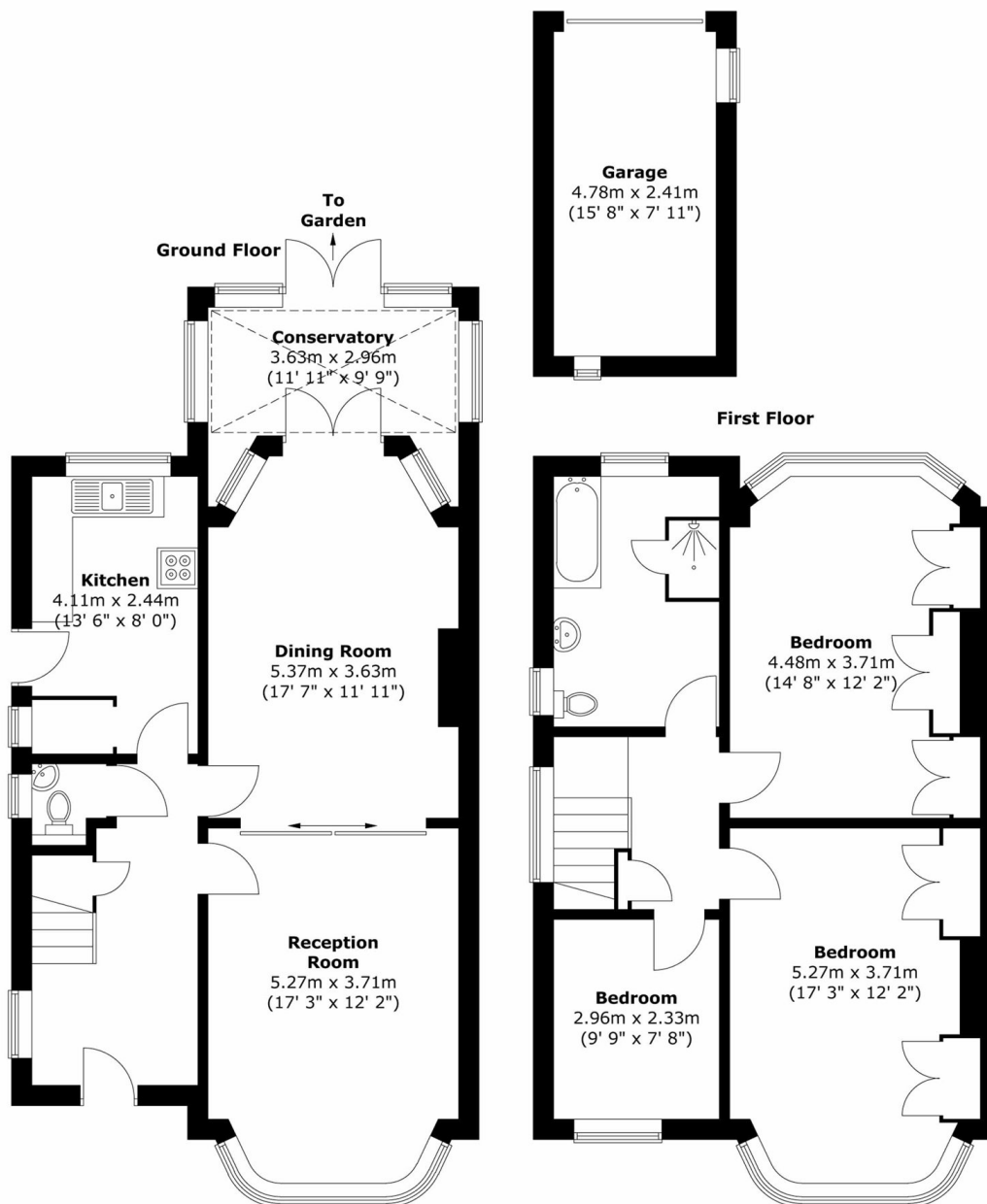

Total area (approx.) : 132.4 sq. m (1425 sq. ft)
Total garage area (approx.) : 11.5 sq. m (124 sq. ft)

Dexters

Norbury
1341 London Road
Norbury
SW16 4BE
Sales
020 8629 8028

Energy Rating: C. We aim to make our particulars both accurate and reliable. However they are not guaranteed; nor do they form part of an offer or contract. If you require clarification on any points then please contact us, especially if you're traveling some distance to view. Please note that appliances and heating systems have not been tested and therefore no warranties can be given as to their good working order.

 **RICS** | Regulated
Estate Agent
and Letting Agent

[dexters.co.uk](https://www.dexters.co.uk)