



Bishops Park Road, SW16

£2,200 Per calendar month

Dexters



Bishops Park Road, SW16

Welcoming this exceptionally well-presented three double bedroom flat perfect for a family or sharers. The accommodation's interior is in excellent condition, consisting of a large reception/dining room, opening to a modern kitchen and with a stylish updated bathroom. The property boasts a generous sized private garden and is located close to shops, amenities and Norbury station.

Bishops Park Road is conveniently situated just 0.2 Miles from Norbury train station and the town centre, which offers a variety of local restaurants and shops. The property also benefits from easy access to local schools, including state and grammar schools, and the open green space of Norbury Park, making it an ideal location for families.

Features

Three double bedrooms

Modern kitchen

Excellent condition

Ground floor apartment

Private garden

Moments from station







Bishops Park Road, London, SW16

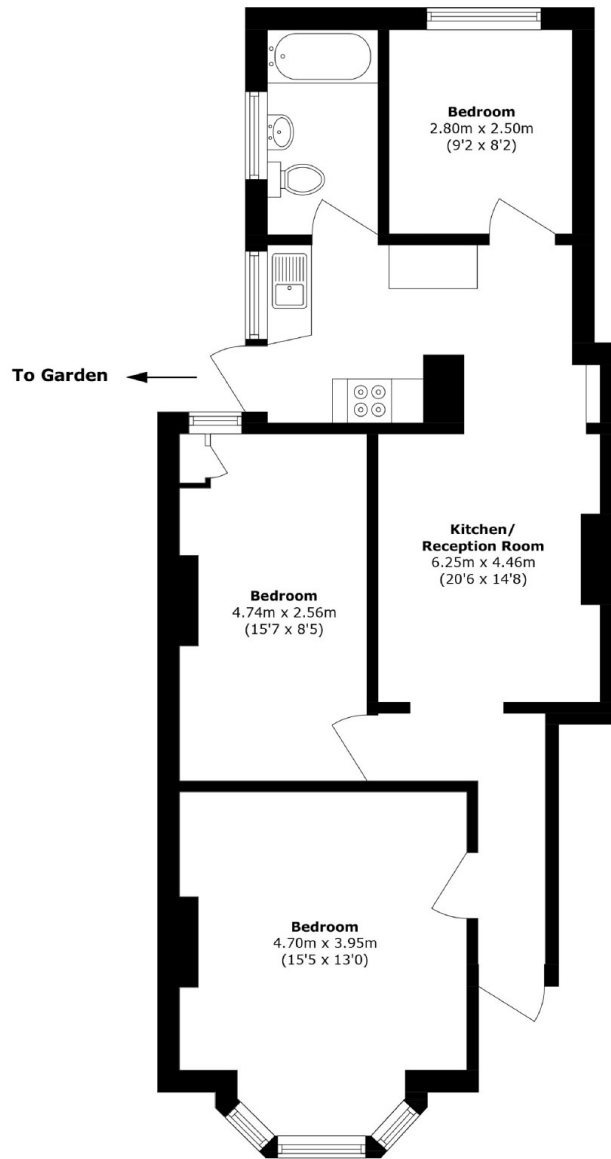

Total area (approx.): 69.3 sq. m (745.9 sq. ft)

Dexters

Norbury
1341 London Road
Norbury
SW16 4BE
Lettings
020 8629 8029

Energy Rating: . We aim to make our particulars both accurate and reliable. However they are not guaranteed; nor do they form part of an offer or contract. If you require clarification on any points then please contact us, especially if you're traveling some distance to view. Please note that appliances and heating systems have not been tested and therefore no warranties can be given as to their good working order.

 **RICS** | Regulated
Estate Agent
and Letting Agent

[dexters.co.uk](https://www.dexters.co.uk)