



Granville Gardens, SW16
£575,000

Dexters



Granville Gardens, SW16

Situated in a quiet cul-de-sac, this charming three bedroom family home offers well-proportioned accommodation and a welcoming feel throughout, making it an ideal purchase for families or first time buyers alike.

The accommodation comprises a bright and inviting front reception room and a well presented kitchen with additional storage space on the ground floor. Upstairs offers two well proportioned double bedrooms, a comfortable single bedroom, and a family bathroom. Externally, the property benefits from a south facing rear garden.

This is a residential street in South London, situated close to Norbury train station (approx. 0.2 miles) and local amenities, making it a popular, well connected location.

Features

- 3 Bedrooms
- South Facing Garden
- 0.2 Miles From Norbury Station
- Freehold
- Quiet Street
- EPC: C







Granville Gardens, London, SW16

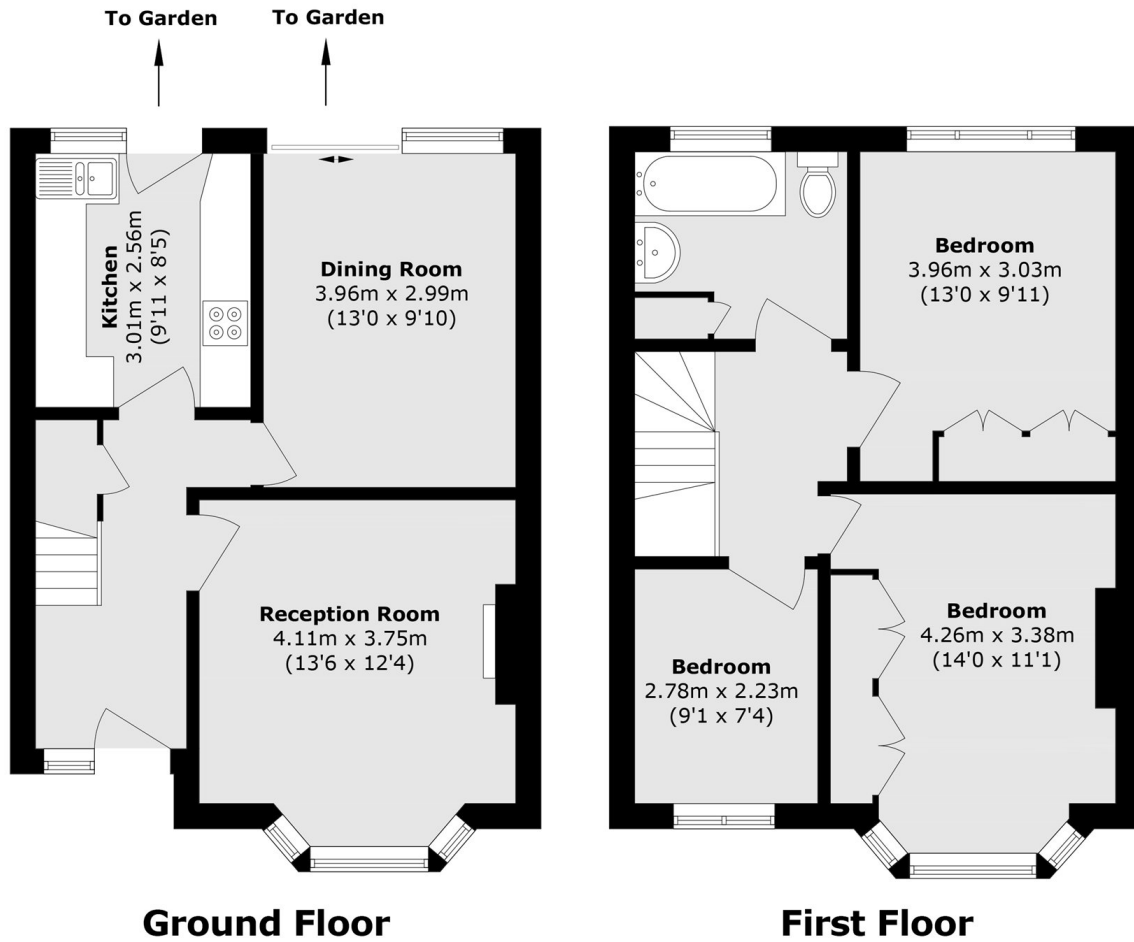

Total area (approx.): 88.7 sq. m (954.7 sq. ft)