



## Leysfield Road, W12

£450,000



- Ground Floor
- Great Potential

- Share Of Freehold
- Large Windows

- High Ceilings
- Good Transport Links

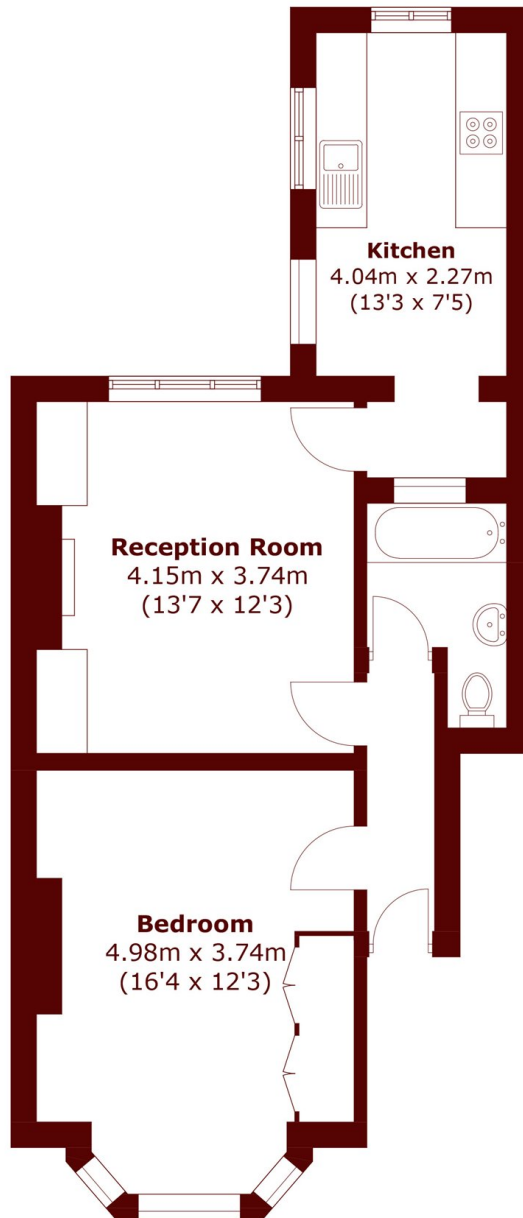

Total area (approx.): 52.7 sq. m (567.3 sq. ft)

## Marsh & Parsons Askew Road

120 Askew Road, London,  
W12 9BL  
020 8102 0123