



## Poynders Road, SW4

£575,000

🛏️ 2 🛁 1 🛋️ 1 📚 B

- Two Bedrooms
- Modern Apartment
- Gated Parking
- Chain Free
- Great Condition
- Secure

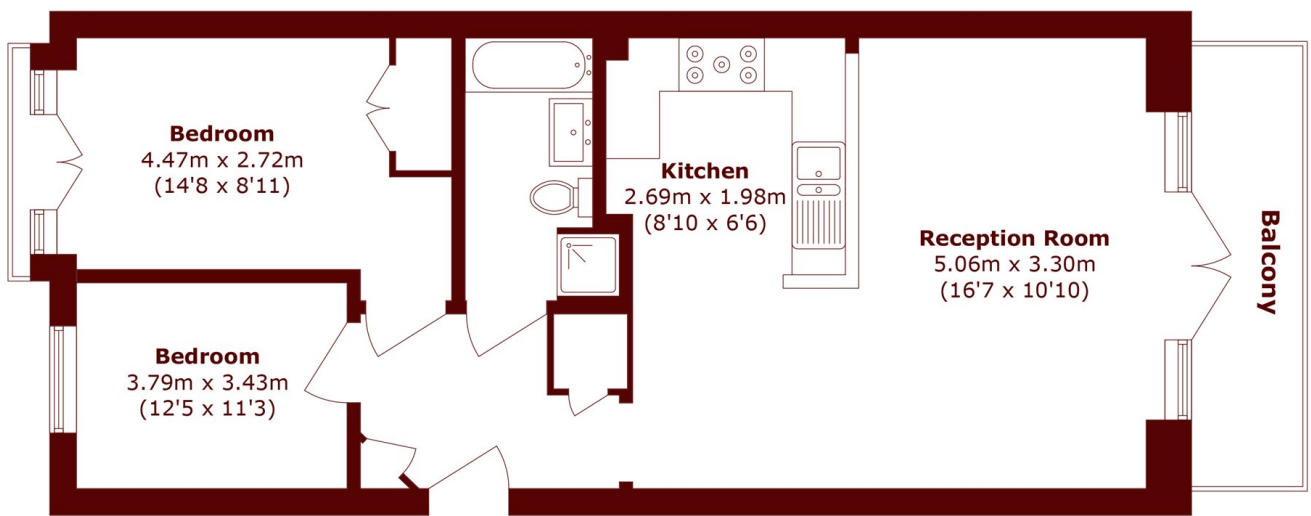

Total area (approx.): 62.3 sq. m (670.5 sq. ft)  
Balcony area (approx.): 6.1 sq. m (65.6 sq. ft)

**Marsh & Parsons Battersea**  
118 Northcote Road, London,  
SW11 6QP  
020 8673 4377

We aim to make our particulars both accurate and reliable. However, they are not guaranteed; nor do they form part of an offer or contract. If you require clarification on any points then please contact us, especially if you're traveling some distance to view. Please note that appliances and heating systems have not been tested and therefore no warranties can be given as to their good working order.