



North Worple Way, SW14

£460,000



- Charming Edwardian Building
- Spacious And Beautifully Presented
- One Bedroom Flat
- First Floor
- Heart of Mortlake
- Delightful Amenities

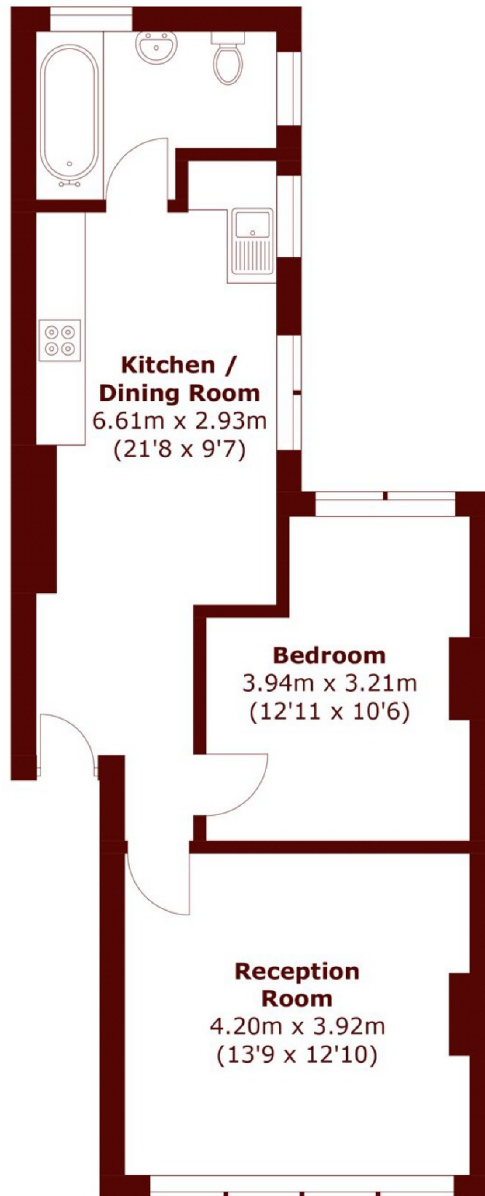

Total area (approx.): 54.2 sq. m (583.4 sq. ft)

Marsh & Parsons Barnes

73-75 Church Road, London,
SW13 9HH
020 8563 8333

We aim to make our particulars both accurate and reliable. However, they are not guaranteed; nor do they form part of an offer or contract. If you require clarification on any points then please contact us, especially if you're traveling some distance to view. Please note that appliances and heating systems have not been tested and therefore no warranties can be given as to their good working order.