



Lambrook Terrace, SW6

£3,000 pcm



- Private Entrance

- Private Garden

- Newly renovated



ABOUT THE PROPERTY

An exceptional two double bedroom, purpose-built Victorian maisonette with its own private entrance and garden, ideally located in the heart of Munster Village, Fulham.

Finished to a high standard throughout, the property benefits from solid oak flooring to most living areas, full-fibre broadband (FTTP up to 1.6Gbps), Ring security cameras and doorbell, USB-C power sockets, Hive heating, Banham locks and a Banham police-monitored alarm system. The fully fitted kitchen includes integrated appliances and opens directly onto a private garden.

Both bedrooms are generous doubles with built-in wardrobes, bespoke shutters to the principal bedroom and made-to-measure blinds to the second. There is a contemporary shower room with walk-in shower, a separate guest WC, and a bright reception/dining room. Recently redecorated throughout, including the exterior.

Superbly located close to the shops, cafés and restaurants of Munster and Fulham Roads, moments from Bishop's Park, the Thames Path, Nuffield Health Club and the new Fulham Pier. Parsons Green and Putney Bridge stations (District Line) and excellent bus links are within walking distance.

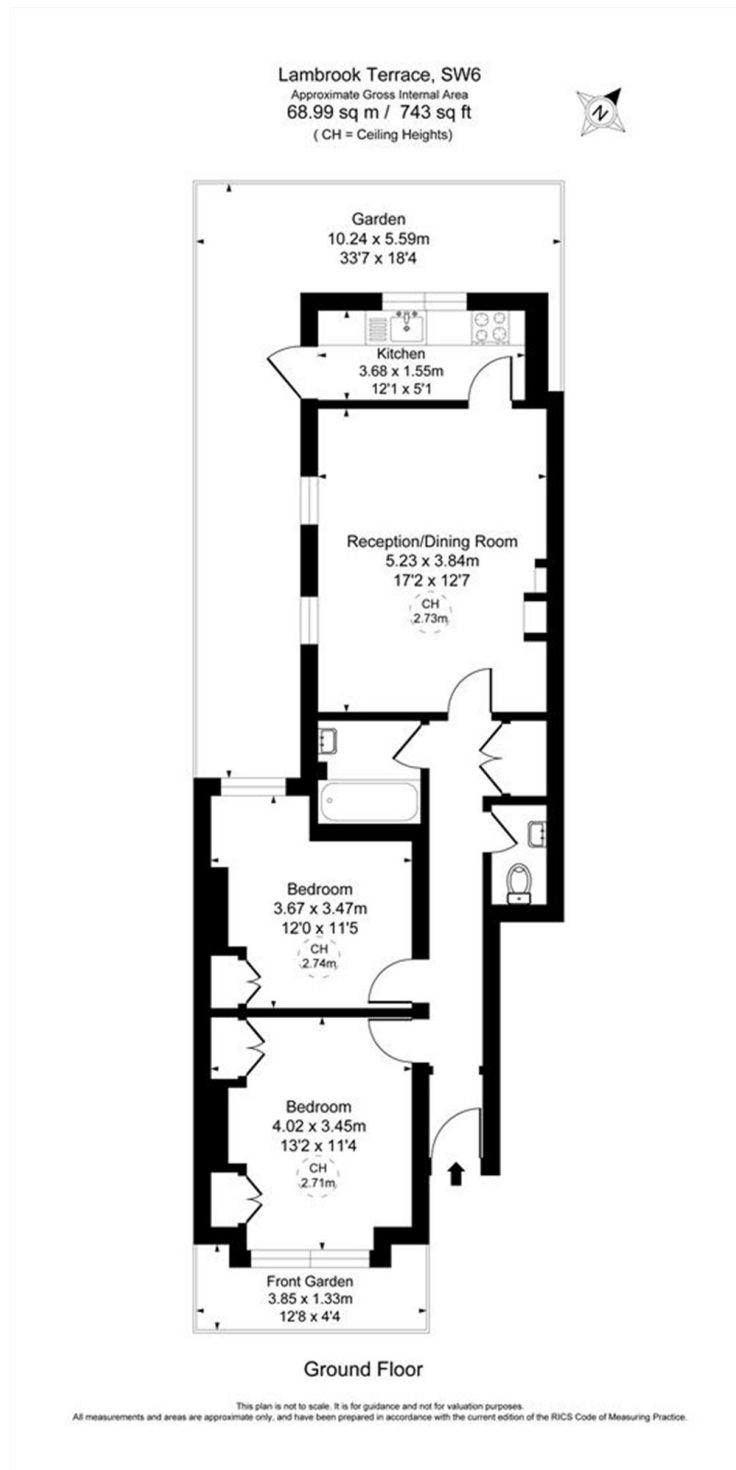

Marsh & Parsons Bishops Park

333 Fulham Palace Road,
London, SW6 6TE
020 7993 9888

We aim to make our particulars both accurate and reliable. However, they are not guaranteed; nor do they form part of an offer or contract. If you require clarification on any points then please contact us, especially if you're traveling some distance to view. Please note that appliances and heating systems have not been tested and therefore no warranties can be given as to their good working order.