



Edith Road, W14

£325,000



- One Bedroom
- Raised Ground Floor
- Separate Kitchen
- Olympia London
- Quiet Location
- Naturally Bright

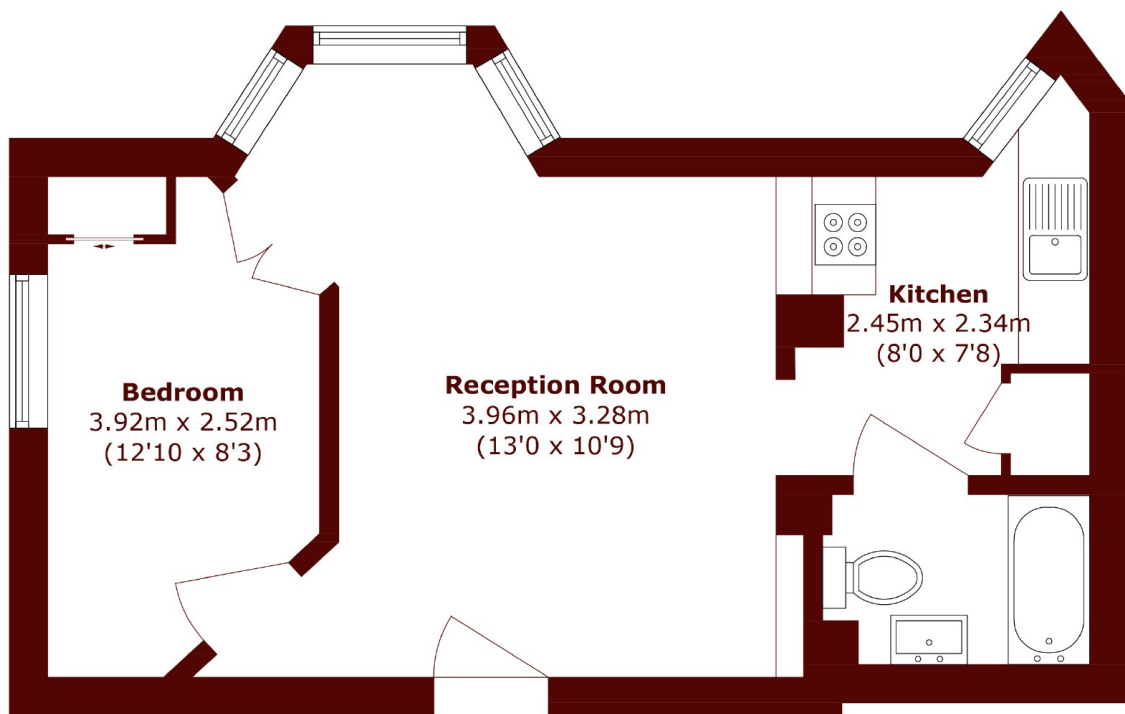

Total area (approx.): 33.7 sq. m (362.7 sq. ft)

Marsh & Parsons Brook Green

107-109 Shepherds Bush
Road, London, W6 7LP
020 7605 7765