



Tulse Hill, SW2

£300,000



- Two Double Bedrooms
- Large Footprint
- Proximity to Brockwell Park
- Chain Free
- Blank Canvas
- Generous Kitchen





ABOUT THE PROPERTY

A charming and well positioned two double bedroom apartment extending to just shy of 600 sqft with a large reception room, a generous separate kitchen with wall and base units, a three piece bathroom and additional w/c. The property is sold chain free.

Woodruff House is ideally located for easy access to central Brixton and Herne Hill. It is minutes from the green open spaces of Brockwell Park with its Lido and tennis courts. Brixton Stations (Victoria Line and National Rail) and Streatham Hill (National Rail) are both within close proximity.



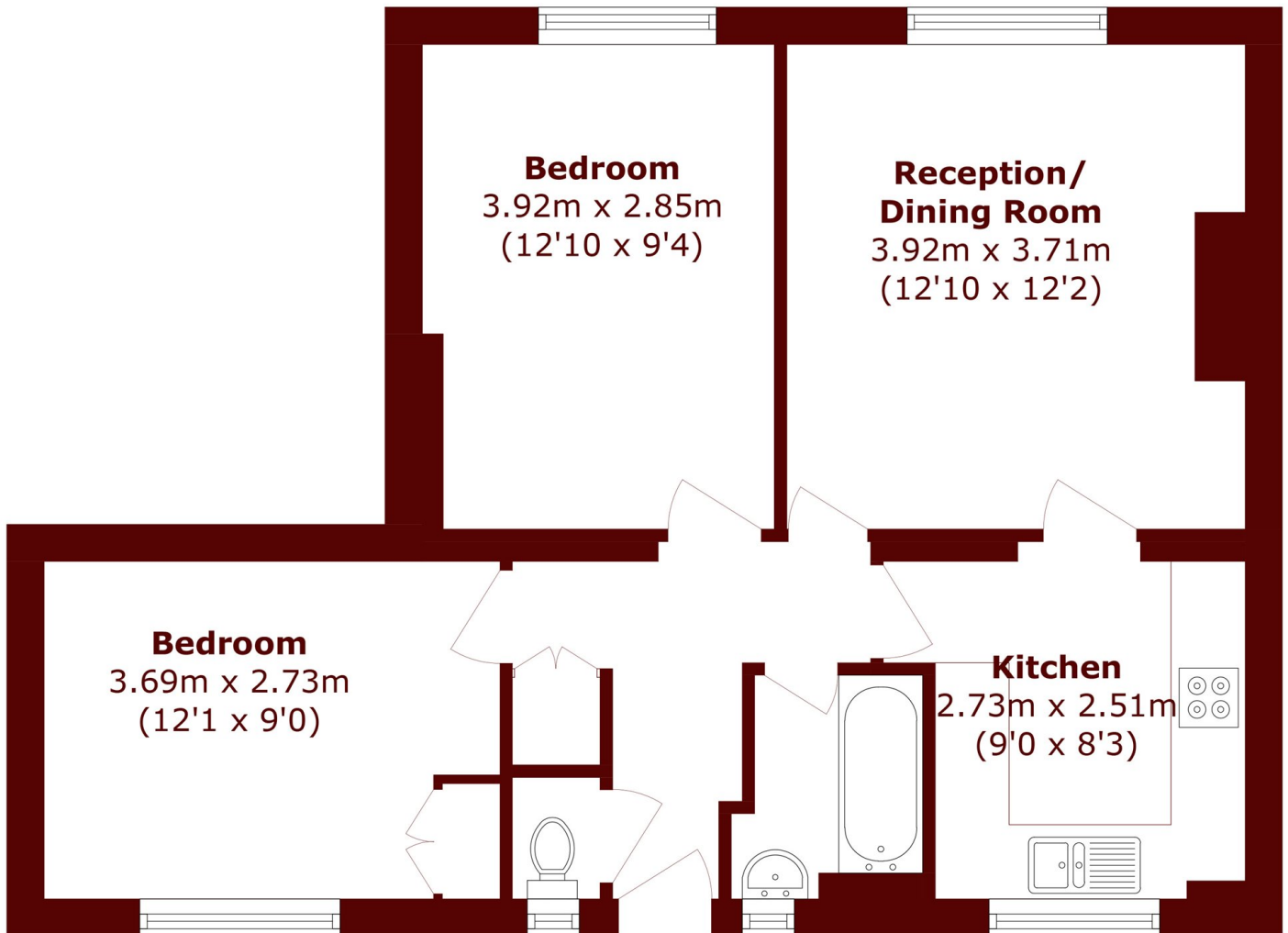

Total area (approx.): 54.3 sq. m (584.4 sq. ft)

Marsh & Parsons Brixton
400-402 Coldharbour Lane,
London, SW9 8LF
020 7733 4595

We aim to make our particulars both accurate and reliable. However, they are not guaranteed; nor do they form part of an offer or contract. If you require clarification on any points then please contact us, especially if you're traveling some distance to view. Please note that appliances and heating systems have not been tested and therefore no warranties can be given as to their good working order.