

Osnaburgh Street, NW1

£700,000



- No Onward Chain
- One Double Bedroom

- Office Room
- Family Bathroom

- Communal Gardens
- Modern Finish

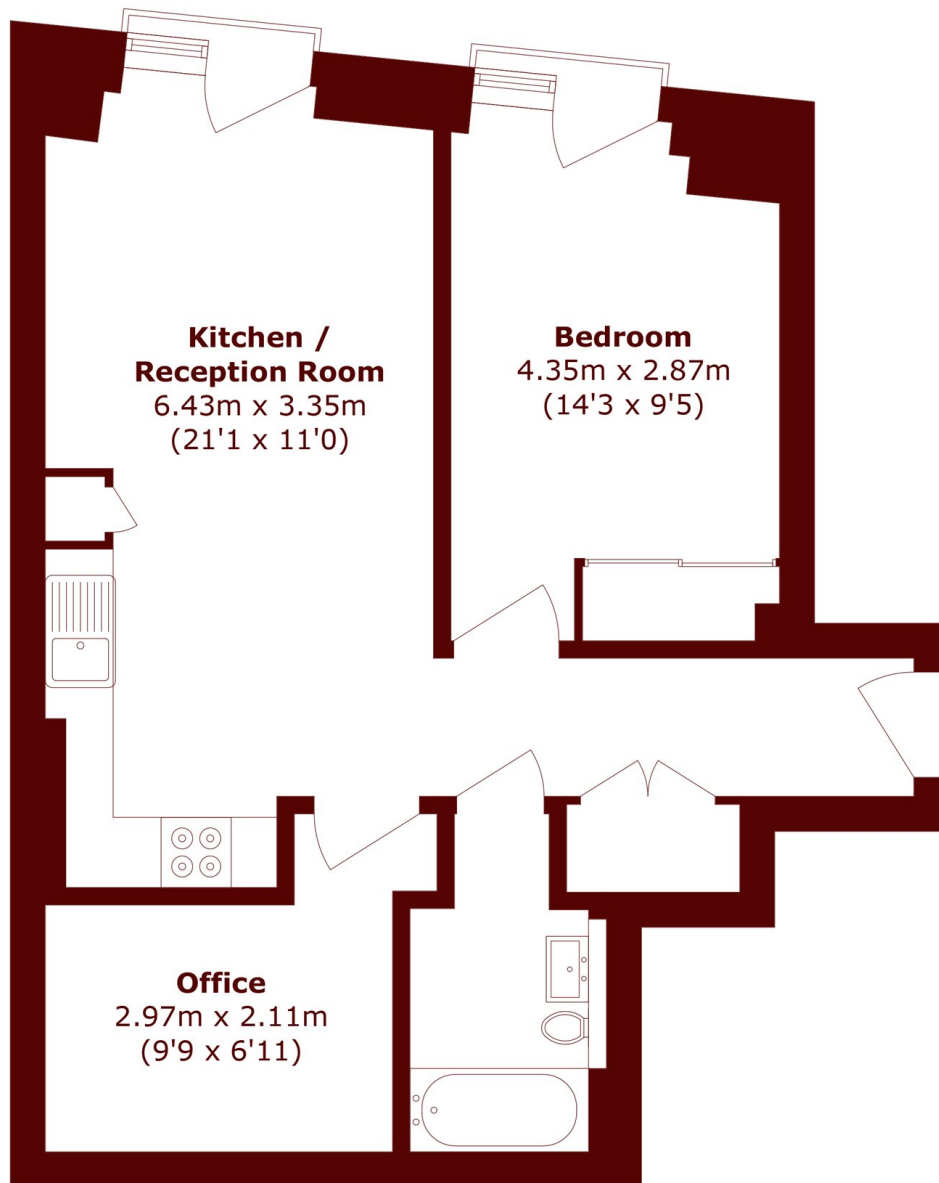

Total area (approx.): 54.5 sq. m (586.6 sq. ft)

Marsh & Parsons Camden

27 Parkway, London, NW1
7PN
020 7244 2200