



Hetherington Road, SW4

£625,000



- Victorian conversion flat
- Generous living space
- West facing garden
- Long lease - 187 years
- Quiet residential street
- Chain free

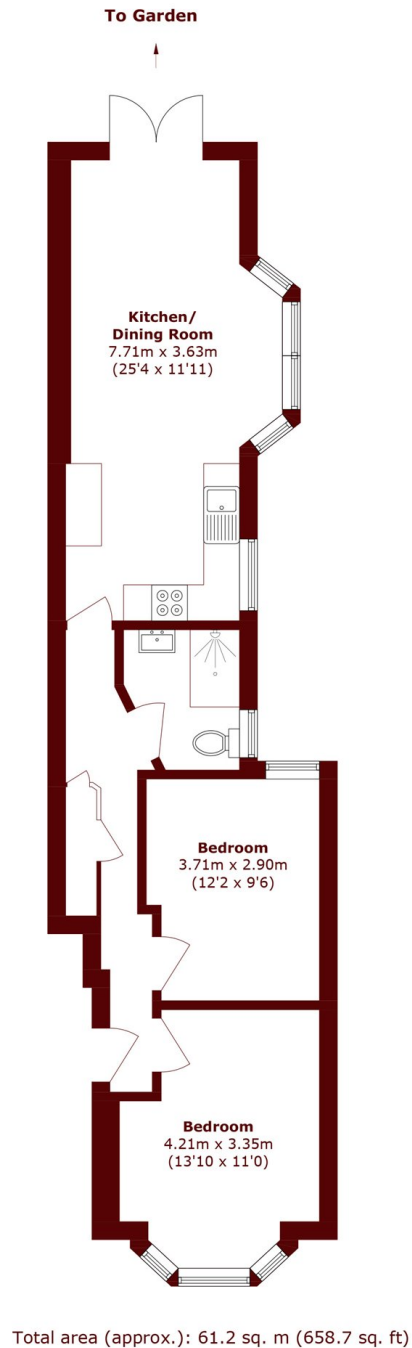

Marsh & Parsons Clapham

28 Old Town, London, SW4

OLB

020 7501 3666

We aim to make our particulars both accurate and reliable. However, they are not guaranteed; nor do they form part of an offer or contract. If you require clarification on any points then please contact us, especially if you're traveling some distance to view. Please note that appliances and heating systems have not been tested and therefore no warranties can be given as to their good working order.