



Landor Road, SW9

£475,000



- Guide Price £475,000 - £500,000

- Two bedrooms

- Private garden

Landor Road, SW9

APPROX. GROSS INTERNAL FLOOR AREA 46.83 SQ.M / 504 SQ.FT

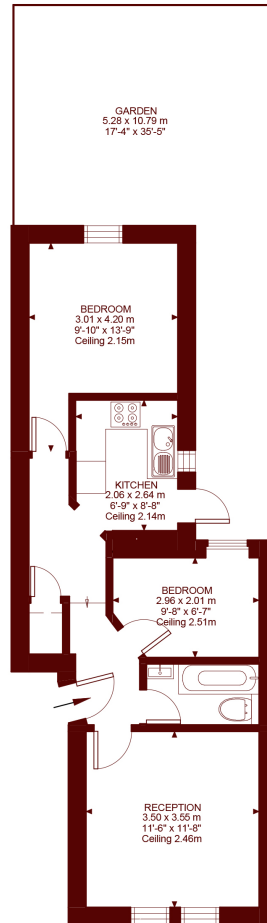

GROUND FLOOR

KEY: CH = Ceiling Height
Restricted Head Height

The floor plan is not to scale and measurements and areas shown are approximate and therefore should be used for illustrative purposes only.
The plan has been prepared in accordance with the RICS code of Measuring Practice and whilst we have confidence in the information produced, it must not be relied on.
If there is any aspect of particular importance, you should carry out or commission your own inspection of the property.

Marsh & Parsons Clapham

28 Old Town, London, SW4

0LB

020 7501 3666