



Shirley Road, W4

£550,000



- One Bedroom
- Recently Renovated
- Private Garden
- Share Of Freehold
- Close To Transport
- Period Conversion

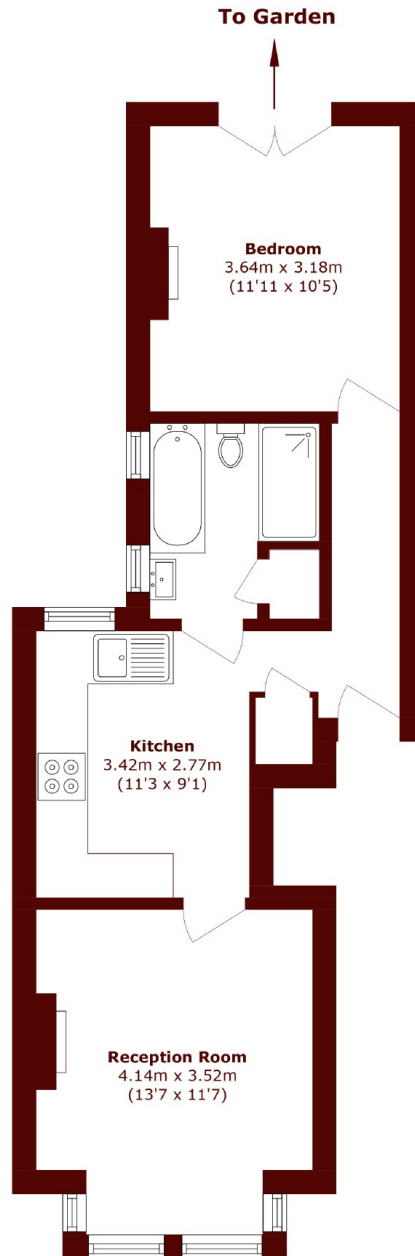

Total area (approx.): 46.2 sq. m (497.2 sq. ft)

Marsh & Parsons Chiswick

34-38 Turnham Green
Terrace, London, W4 1QP
020 8994 2556

We aim to make our particulars both accurate and reliable. However, they are not guaranteed; nor do they form part of an offer or contract. If you require clarification on any points then please contact us, especially if you're traveling some distance to view. Please note that appliances and heating systems have not been tested and therefore no warranties can be given as to their good working order.