



Eardley Crescent, SW5

£600,000



- Two Double Bedrooms
- Second Floor Floor
- Seperate Kitchen
- Natural Light Throughout

- Kensington and Chelsea
- Earl's Court Station

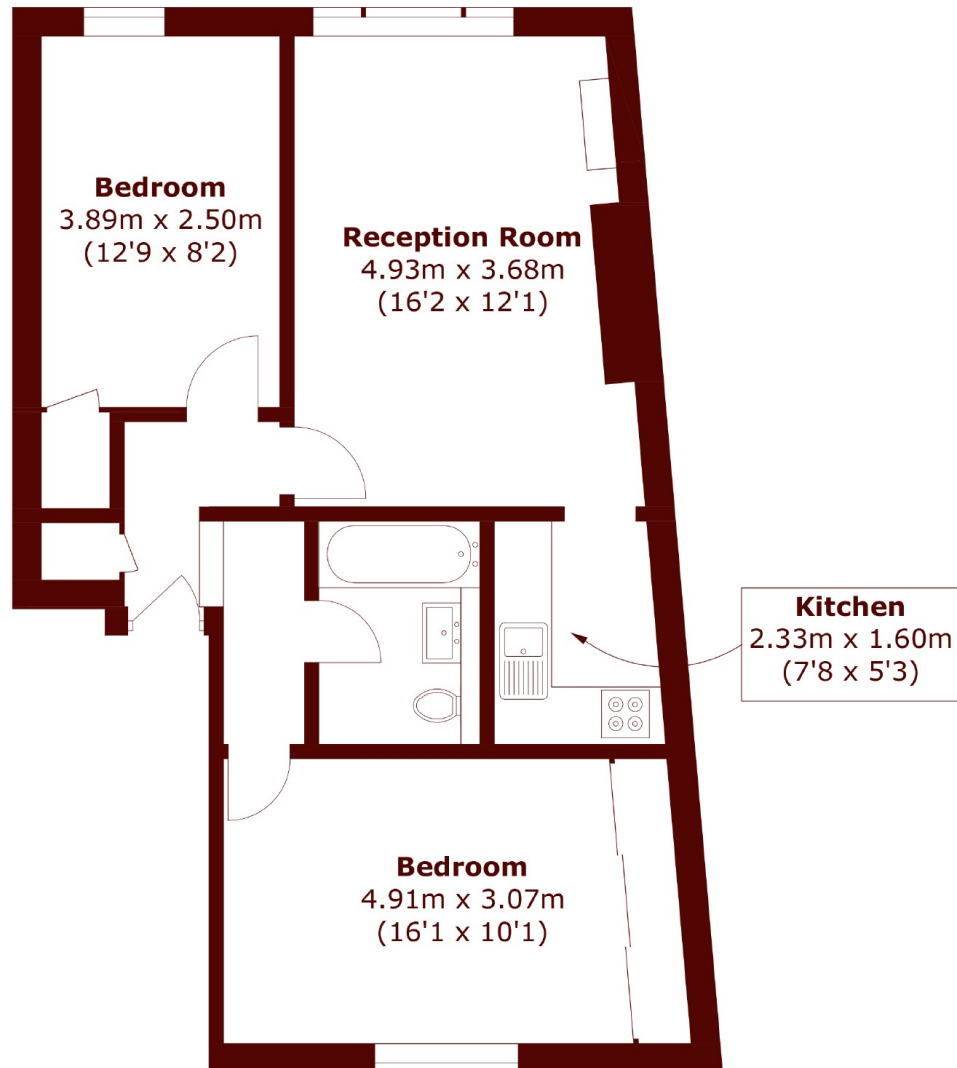

Second Floor

Total area (approx.): 58.3 sq. m (627.5 sq. ft)

Marsh & Parsons Earls Court

246 Old Brompton Road,
Earls Court, London, SW5
020 7590 0800