



## Courtfield Gardens, SW5

£1,150,000



- Two Double Bedrooms
- Two Bathrooms

- Garden Square Access
- Lift

- Stucco Fronted
- Transport Links

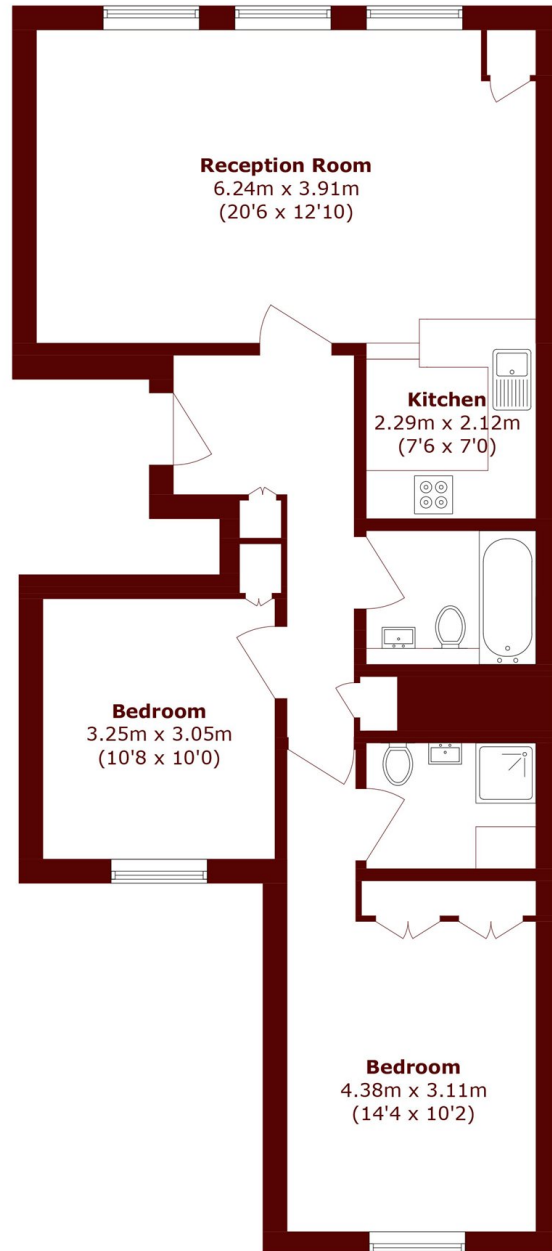

Total area (approx.): 71.0 sq. m (764.2 sq. ft)

## Marsh & Parsons South Kensington

29 Harrington Road, London,  
SW7 3HD  
020 7590 0800