



## Blenheim Crescent, W11

£760,000



- Two Bedrooms
- Wooden Flooring

- Modern Kitchen
- Natural Light

- Popular Location
- Period Conversion

## BLenheim CRESCENT, W11

Approx. gross internal area  
549 Sq.Ft. / 51 Sq.M.

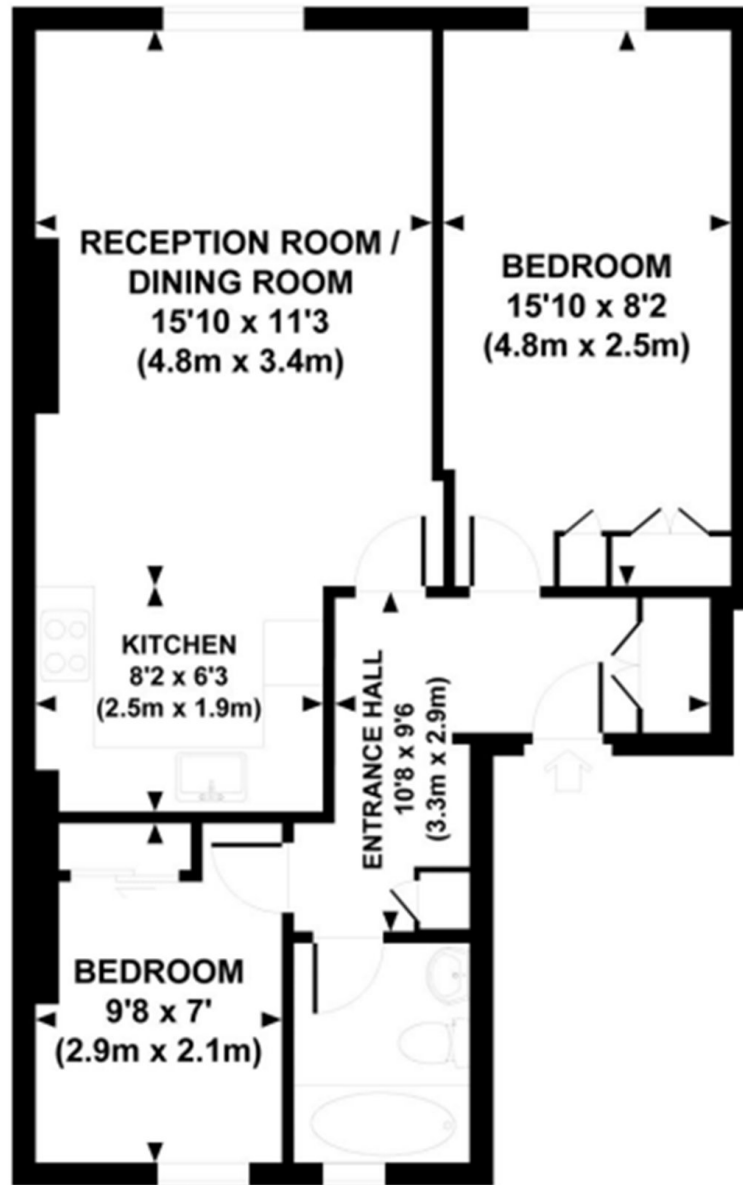

**THIRD FLOOR**

### Marsh & Parsons Holland Park

57 Norland Square, London,  
W11 4QJ  
020 7605 6890