



Elsham Road, W14

£900,000



- Two Bedrooms
- Natural Light
- Spacious Reception
- Excellent Storage
- Wonderful Location
- Separate Kitchen

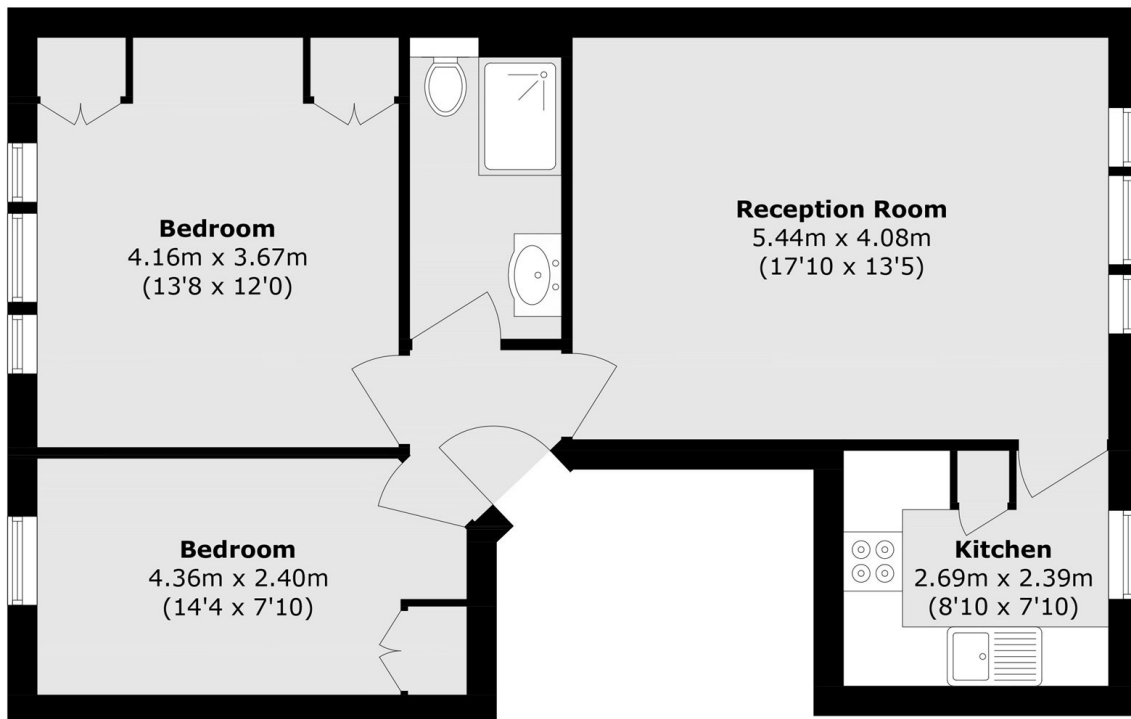

Second Floor

Total area (approx.): 62.8 sq. m (675.9 sq. ft)

Marsh & Parsons Holland Park

57 Norland Square, London,
W11 4QJ
020 7605 6890