



Westminster Bridge Road, SE1

£400,000



- Share of Freehold
- Modern Interior
- Excellent Location
- Period Building
- Open Plan Living
- Chain Free





ABOUT THE PROPERTY

A beautifully presented two bedroom apartment occupying the second floor of an elegant period building. The property benefits from an abundance of natural light, well proportioned rooms, and a stylish, contemporary kitchen. Finished with a modern interior throughout, this home combines period charm with sleek, modern living

Located moments from Lower Marsh and The Cut, home to the Old Vic Theatre and providing the areas rich selection of eateries and pubs. Nearby transport links include Lambeth North station (Bakerloo line) and Waterloo mainline station. The area is also ideally located for the City, while Westminster, Covent Garden and Trafalgar Square are within easy walking distance.



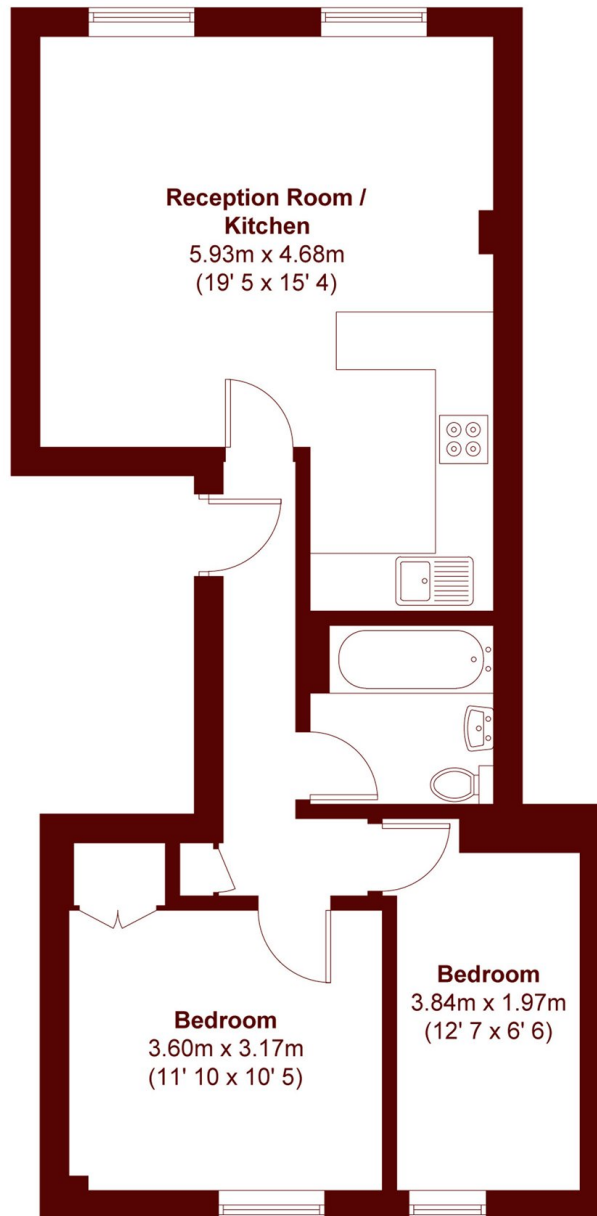

APPROX. GROSS INTERNAL FLOOR AREA
545 SQFT / 50.6 SQM

Marsh & Parsons Kennington

295 Kennington Road,
London, SE11 4QE
020 7587 1533

We aim to make our particulars both accurate and reliable. However, they are not guaranteed; nor do they form part of an offer or contract. If you require clarification on any points then please contact us, especially if you're traveling some distance to view. Please note that appliances and heating systems have not been tested and therefore no warranties can be given as to their good working order.