



Opal Street, SE11

£325,000



- One Bedroom
- First Floor
- Lots of Light
- Balcony
- Communal Gardens
- Excellent Condition





ABOUT THE PROPERTY

A beautifully presented one bedroom apartment set on the first floor of this low rise block. Benefitting from lots of light, with access to private balcony overlooking the well-maintained communal gardens.

Situated on the popular Cottoington Close Estate, the property is located within easy reach of Kennington, Walworth Road, and Elephant and Castle which offers a variety of bars, shops and restaurants. The green open spaces of Kennington Park are also close by. Transport links include Kennington station (Northern line), Elephant & Castle station (Northern & Bakerloo lines, and overground services). A wide range of bus routes also provide access towards the city and surrounding areas.



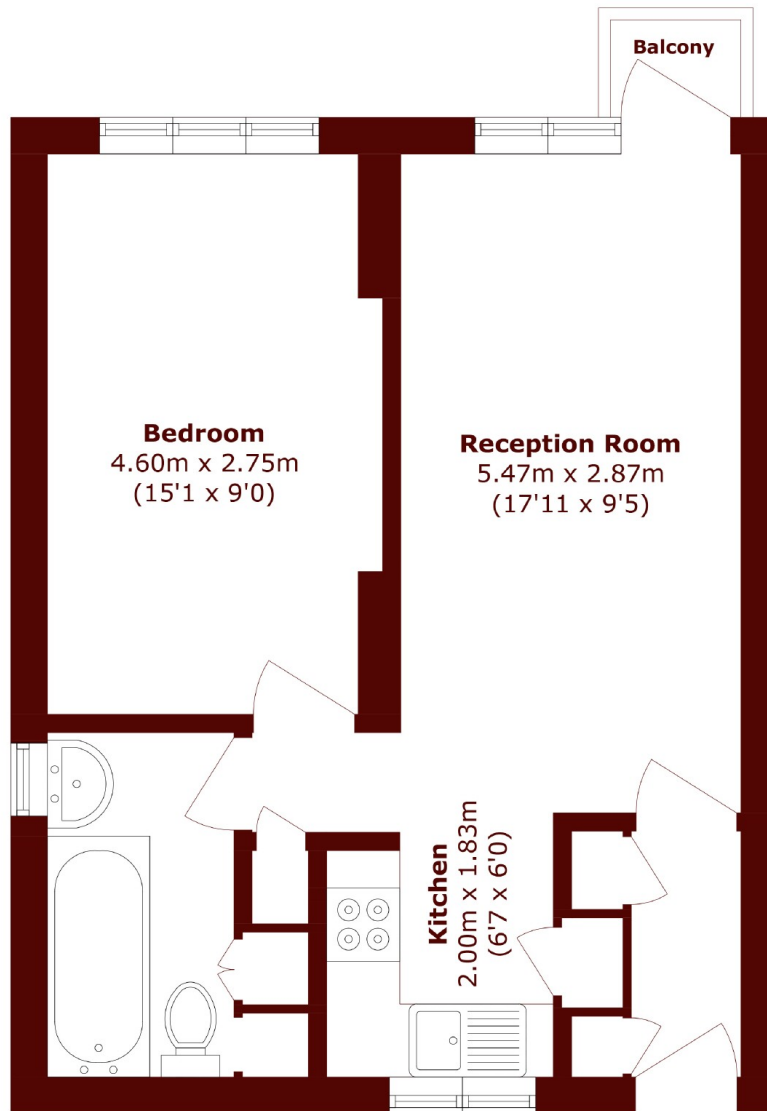

Total area (approx.): 43.1 sq. m (463.9 sq. ft)

Balcony area (approx.): 0.8 sq. m (8.6 sq. ft)

Marsh & Parsons Kennington

295 Kennington Road,
London, SE11 4QE
020 7587 1533