



Winchester Court, W8

£750,000



- Two Double Bedrooms
- Balcony

- Lift Access
- Portered Mansion Building

- Prime Kensington Location
- Share of Freehold

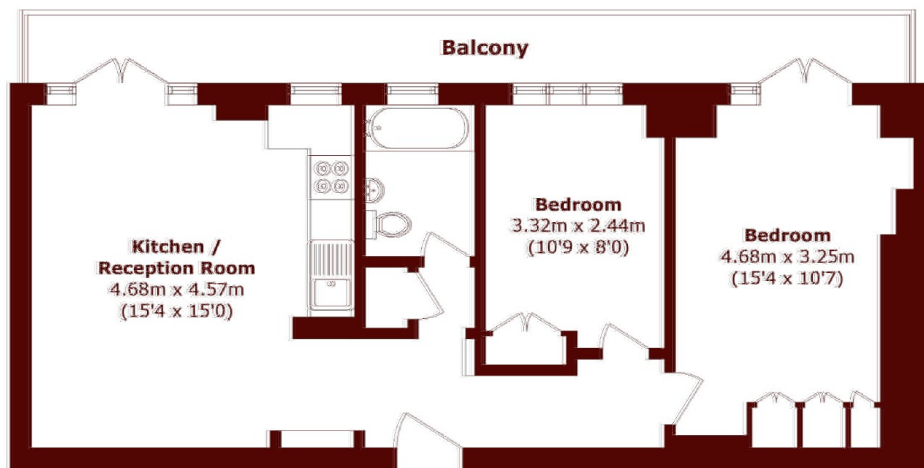

Total area (approx.): 56.3 sq. m (606.0 sq. ft)

Balcony area (approx.): 11.2 sq. m (120.6 sq. ft)

Marsh & Parsons Kensington

9 Kensington Church Street,
London, W8 4LF
020 7368 4450