



Edgware Road, W2

£650 per week (£25,816 pcm)



- South Facing
- Sixth Floor With Lift
- Full of Natural Light
- Two Double Bedrooms
- 24hr Porter
- Excellent transport links nearby

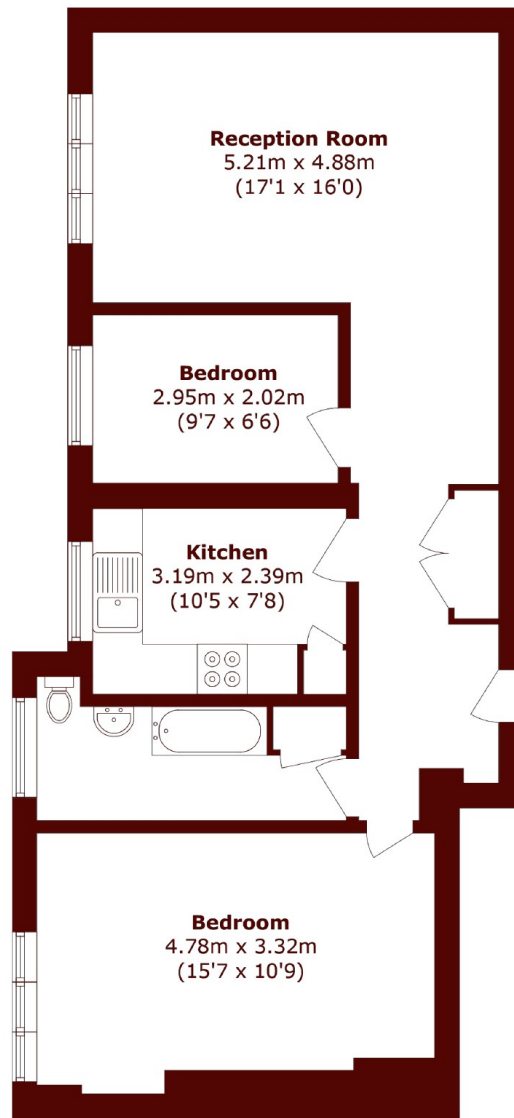

Total area (approx.): 62.8 sq. m (675.9 sq. ft)

Marsh & Parsons Notting Hill

2-6 Kensington Park Road,
London, W11 3BU
020 7313 2890