



Elgin Crescent, W11

£1,300,000



- Private entrance
- High ceilings
- Stunning views
- Southerly garden
- Direct access to private communal gardens
- Prime Notting Hill

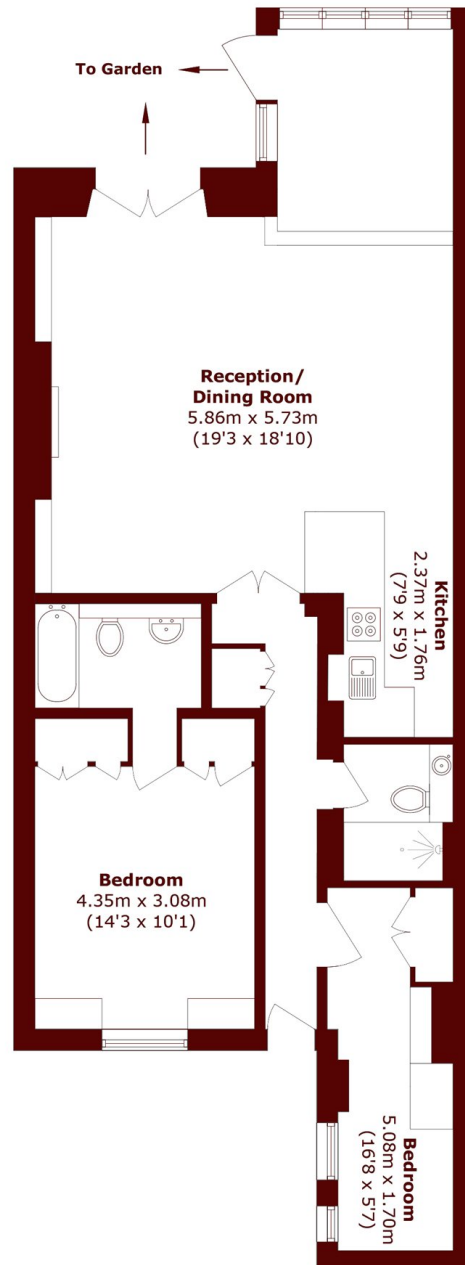

Total area (approx.): 79.9 sq. m (860.0 sq. ft)

Marsh & Parsons Notting Hill

2-6 Kensington Park Road,
London, W11 3BU
020 7313 2890